



Missouri Great Dane

BUYERS ORDER

DEAL #: _____

DATE: _____

SALESMAN: _____

Stock#: ORDER-1	VIN:	2023 DIAMOND CARGO	Price:	\$149,900.00
		Pinnacle Hygienic Series Standard Premium Mattress x 10		\$7,979.00
		SHIPPING TO RICHMOND, CA		<u>\$9,900.00</u>
			Per Unit:	\$167,779.00
			Net Total	<u>\$167,779.00</u>

ALL USED TRAILERS ARE SOLD IN "AS IS" CONDITION, AND NO WARRANTY, EXPRESSED OR IMPLIED IS MADE.

THE EXPRESS WARRANTY OF GREAT DANE TRAILERS, INC., IN RESPECT TO THE GOODS DESCRIBED HEREIN IS IN LIEU OF ANY AND ALL OTHER WARRANTIES, EXPRESSED OR IMPLIED. NO IMPLIED WARRANTY OF MERCHANTABILITY IS MADE AND THERE ARE NO WARRANTIES WHICH EXTEND BEYOND THE DESCRIPTION ON THE FACE HEREOF.



DEAL #: _____

DATE: _____

SALESMAN: _____

NEW TRAILER ORDER - 12-16 WEEKS

P.O REQUIRED BY 12/1/22 TO SECURE TIMELINE

2023 MGD 10 Person Bunk House Specialty Trailer

100"W

90" Ceiling

Aluminum Construction walls/floor/roof wall studs

8" 7 Gauge Steel E-Coated Chassis

(4) 30" Manual Stabilizer Jacks

(3) 7k torsion axles

R7 Wall & Floor Insulation

R14 Floor Insulation

Seamless Gelcoat exterior

All weather roof coating

(10) 30"W x 78" T Entry doors w/windows

Group 27 12V battery

Converter

LED Exterior Lights

Porch lights each door

LED lights per bunk room

Receptacles each room including usb recept by beds

Coin rubber floor

White fiberglass walls & ceiling

Each room has flip down countertop, 2 coat hooks, folding chairs, individual A/C unit, individual heater, smoke detector, fire ext. floor drains

ALL USED TRAILERS ARE SOLD IN "AS IS" CONDITION, AND NO WARRANTY, EXPRESSED OR IMPLIED IS MADE.

THE EXPRESS WARRANTY OF GREAT DANE TRAILERS, INC., IN RESPECT TO THE GOODS DESCRIBED HEREIN IS IN LIEU OF ANY AND ALL OTHER WARRANTIES, EXPRESSED OR IMPLIED. NO IMPLIED WARRANTY OF MERCHANTABILITY IS MADE AND THERE ARE NO WARRANTIES WHICH EXTEND BEYOND THE DESCRIPTION ON THE FACE HEREOF.



TERMS AND CONDITIONS

IT IS FURTHER UNDERSTOOD AND AGREED:

This purchase and the performance of the parties thereunder shall be construed in accordance with and governed by the laws of the State of Missouri. Buyer acknowledges receipt of the customer's copy of this order fully completed at the time of its execution by customer.

If Buyer pays the balance due Seller with a check and the check subsequently is dishonored due to insufficient funds or by stop-payment of Buyer, then Buyer agrees that Seller has immediate right to possession of equipment upon demand and shall make such equipment available to Seller at Seller's place of business or another location agreed upon by Buyer and Seller.

1. **CANCELLATION**— If Buyer refuses to accept and promptly pay for equipment in full as provided in this order, or if Buyer cancels this order prior to delivery, Buyer agrees that Seller would suffer financial loss and damage thereby; in such case Buyer agrees that Seller has option to claim as his damages either: (a) ten (10) percent of the contract price of the equipment as liquidated damages or; (b) the actual damages (including loss of profit on the entire transaction) in lieu of liquidated damages; (c) the Buyer is entitled to a credit against damages computed by either method a or b above, the credit to include the cash deposit, if any, and credit for the value of any trade-in equipment. If the credit given to Buyer exceeds the damages computed under a or b above, a refund would be due Buyer.
2. That the purchaser, before or at time of delivery to him of the vehicle covered by Purchase contract, will execute such other forms of agreements or documents as may reasonably be required by the Dealer.
3. If the Manufacturer makes any changes in the model or design of any accessories and/or parts of any new vehicles at any time, it does not create any obligation on the part of the Dealer to make corresponding changes in the vehicle covered by this order either before or subsequent to the delivery of such vehicle to the Purchaser.
4. **TRADE-INS**—The Buyer warrants that the equipment, if any, to be transferred to Seller (the "trade-ins") in part payment of the purchase price for the equipment to be purchased from Seller hereunder is free from all liens, claims and encumbrances and that Buyer has good marketable title thereto and full right to transfer same, except as noted on the face of the order and that description of same given in this order is true and accurate in all respects including but not limited to make, year, model and serial number. Buyer shall deliver such trades to Seller as specified on the face of the order — the trade-ins to be transferred on or before delivery of the equipment purchased hereunder in the same condition or appearance as at the time of inspection by Seller. Seller may refuse delivery of the trade-in if, in its discretion, the condition or appearance of the trade-in has deteriorated or has changed since the original inspection and Seller may require Buyer to make immediate payment, in cash, of the amount otherwise specified on the face of this order as trade-in allowance. If the trade-in is not delivered to Seller as set forth above on or before delivery of equipment purchased hereunder, Seller may charge Buyer rental fee which would be at a rate normally used and customary for such equipment. Trade-ins not available at time of delivery shall be delivered to Seller at Customer's expense.
5. Any increase in price, to a retail customer, after having accepted an order of purchase or a contract from a buyer, is prohibited except that (a) a trade-in vehicle may be reappraised if it subsequently suffered damage, or parts and/or accessories have been removed or replaced, or (b) as provided in (6) following.
6. The Purchaser hereby agrees to accept delivery of the ordered vehicle prior to the specified delivery date if the vehicle is available for delivery by the Dealer prior to the specified delivery date.
7. **The dealer shall not be liable to the Buyer for any consequential damages, damages to property, damages for loss of use, lost of time, loss of profits, or income, or any other incidental damages arising out of the sale or use of purchased vehicle.**
8. Except for any manufacturer's or other express warranty which exists on this vehicle, the entire risk as to the quality and performance of the vehicle is with the buyer, and should the vehicle prove defective following the purchase, the Buyer will assume the entire cost of all servicing and repair, specifically but not limited to tires and refrigeration unit.
9. The dealer is not a party to any manufacturer's or other third party warranty applicable to the vehicle but may be a representative for the purposes of services or repairs under such warranty.
10. No oral representations are binding unless written on this form and all terms of the agreement are printed or written herein.
Buyer's Representations: I agree to the terms and conditions the same is if it were printed above my signature. In consideration of the mutual agreements of the parties herein I represent and warrant, "(a) that I am 18 years of age or older, (b) that I have full power, right and lawful authority to dispose of the vehicle to be traded in, (c) that I will defend same against all claims and that it is free from all liens and encumbrances except _____
11. **THE REFRIGERATION UNIT DESCRIBED ON THIS CONTRACT MAY NOT BE THE SAME AGE AS THE TRAILER.**
12. The Dealer's obligation to deliver the ordered vehicle to the purchaser is expressly conditioned upon the manufacturer delivering the vehicle to the dealer.

Exterior/Construction

- 1 100" wide / 90" Ceiling
- 2 Aluminum construction: walls, floor, roof
- 3 8" 7 gauge chassis E-coated black
- 4 14 Gauge c-channel cross member
- 5 (2) Tandem black fenders
- 6 (4) 30" manual stabilizer jacks
- 7 8k Ram Jack
- 8 5/16 Grade 43 Safety Chain; 11,700#
- 9 14K Adjustable pintle hitch
- 10 (6) ST235/80R16 alum black 8 lug tires
- 11 (1) ST235/80R16 alum black spare tire on carrier
- 12 (2) 7K# torsion axles w/ electric brakes
- 13 1.5" bonded side walls
- 14 1.5" foam insulation: walls R7
- 15 Fiberglass insulation: floor R7 - ceiling R14
- 16 Ceiling wrapped in reflective foil
- 17 Seamless Gelcoat exterior siding - white
- 18 Black exterior trim
- 19 5/8" tongue & groove plywood floor decking
- 20 7/16" OSB roof decking
- 21 V-Nose Front
- 22 Black ATP on V-Nose
- 23 All weather rubber roof
- 24 (10) 30" x 78" HD entrance door w smoked glass window with keyless entry with keypad
- 25 (10) privacy shades-1 for each door
- 25 (10) HD adjustable folding solid quad steps
- 26 (10) Long SS Folding Grab Handle-one per door
- 27 Storage Door with Black Trim: 27" x 48" w slam latches

Electrical

- 29 Cam Locks on side of trailer; NO shore cords
- 30 12v Group 27 Battery
- 31 30-60 space load Center
- 33 45 amp electrical converter
- 34 ~~7-way round pin trailer side plug-RV style~~

Electrical cont'd

- 35 HI-temp breakaway switch
- 36 Breakaway Switch & batter w box
- 37 LED stop/turn/running lights
- 38 LED clearance/running lights-top front, middle; bottom front, middle, back
- 40 12v LED porch light at entry doors & Storage door
- 41* (10) electrical outlets-1 per room
- 42 (10) 12v light per room with switch by bed and flip down desk-1 per room

Interior

- 43 Coin Flooring-black
- 44 White Fiberglass on Ceiling & Wall
- 45 (10) flip down counter desktop-1 per room: 30" high off floor
- 46 (20) coat hooks-2 per room
- 47 (10) black folding chairs-1 per room

Entertainment: n/a

Appliances

- 48 (10) individual AC (1per room): Midea MAW05M1BWT or similar
- 49 (10) louvered screened vents for AC-1 per room
- 50 (10) individual heaters (1 per room): Phoenix HS-1500-PHX or similar

Upgrades/Changes

- 51 Insulate all interior walls
- 52 (10) Door catches
- 53 Black ATP on V-nose
- 41a* USB recept by each bed
- 41b* Outlet above desk; outlet below desk for mini fridge
- 54 12 volt night light per bed with switch
- 55 (10) smoke detectors-1 per room
- 56 (1) Fire extinguisher located front storage area
- 57 (10) stickers; 1 per room; indicating where the fire extinguisher is located
- 58 Floor drains: (10) floor drains, 1 per room; should be flat screw cap drain with mesh for bug and critter control

NOTE: Each AC unit must be secured in a 21" wide x 13" box

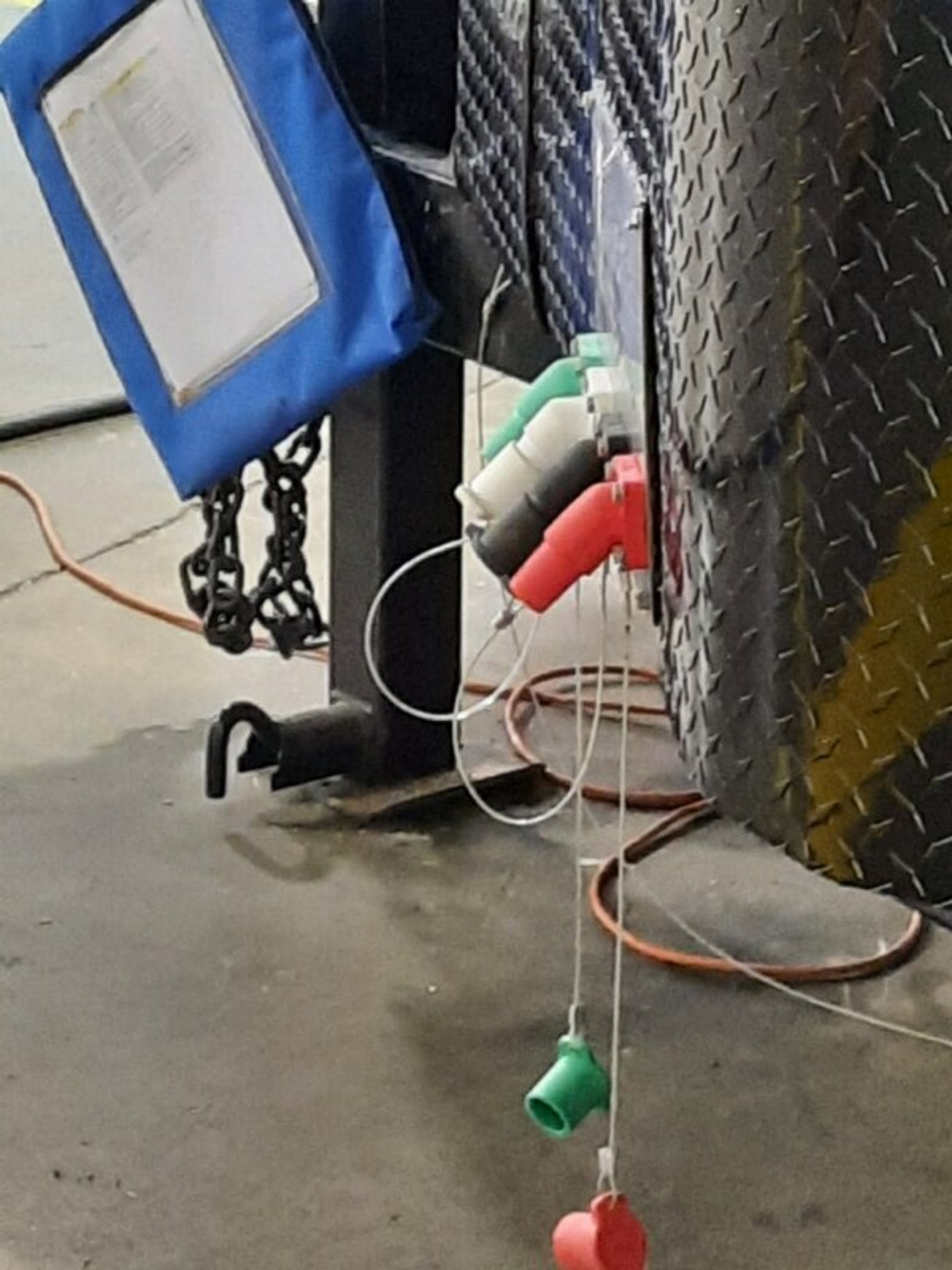

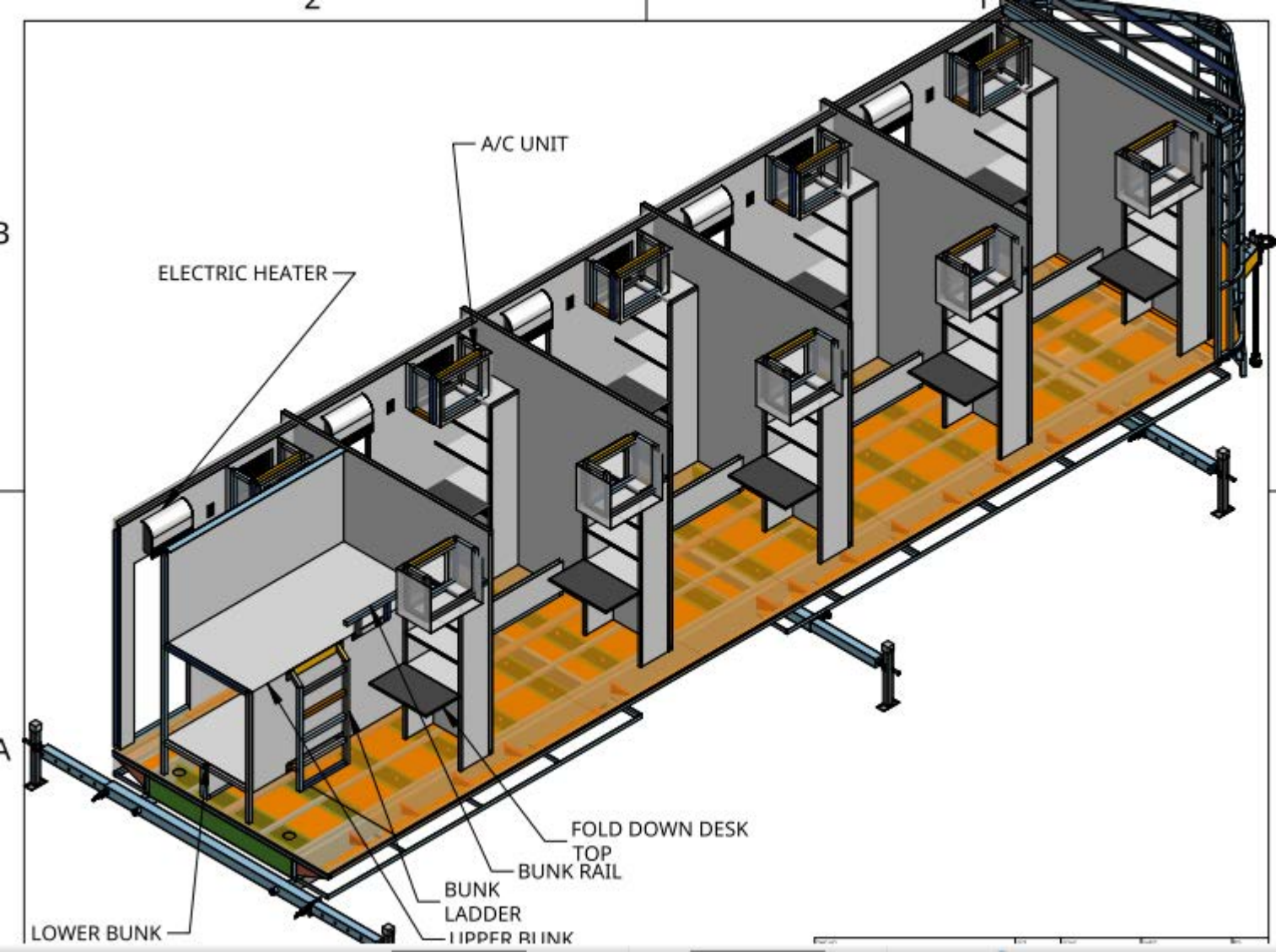

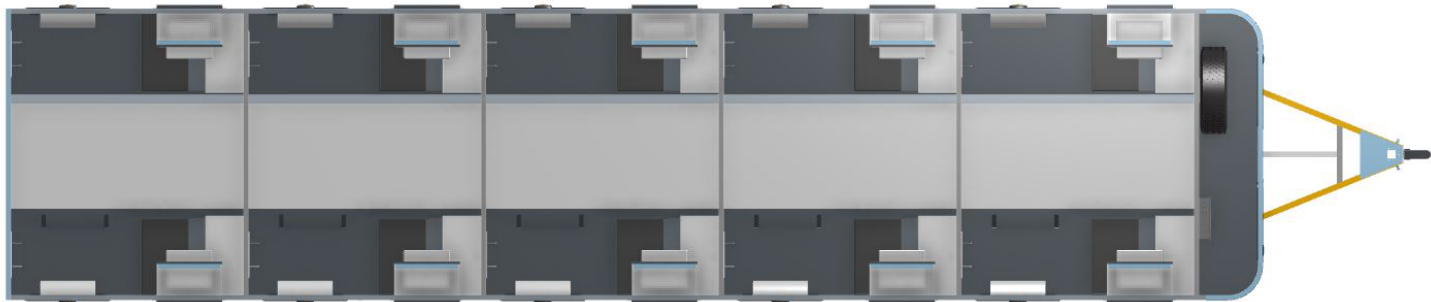

	NAME	DATE			
DRAWN	JON	11/24/2021			
CHECKED			TITLE		
APPROVED					
			INDIVIDUAL ROOM BUNKHOUSE 10R10BBH		
MATERIAL	FINISH		SIZE A	DWG NO. DRW-12596	REV. A
			SCALE 1:80	WEIGHT	SHEET 1 of 5

B

A

2

1

B

A

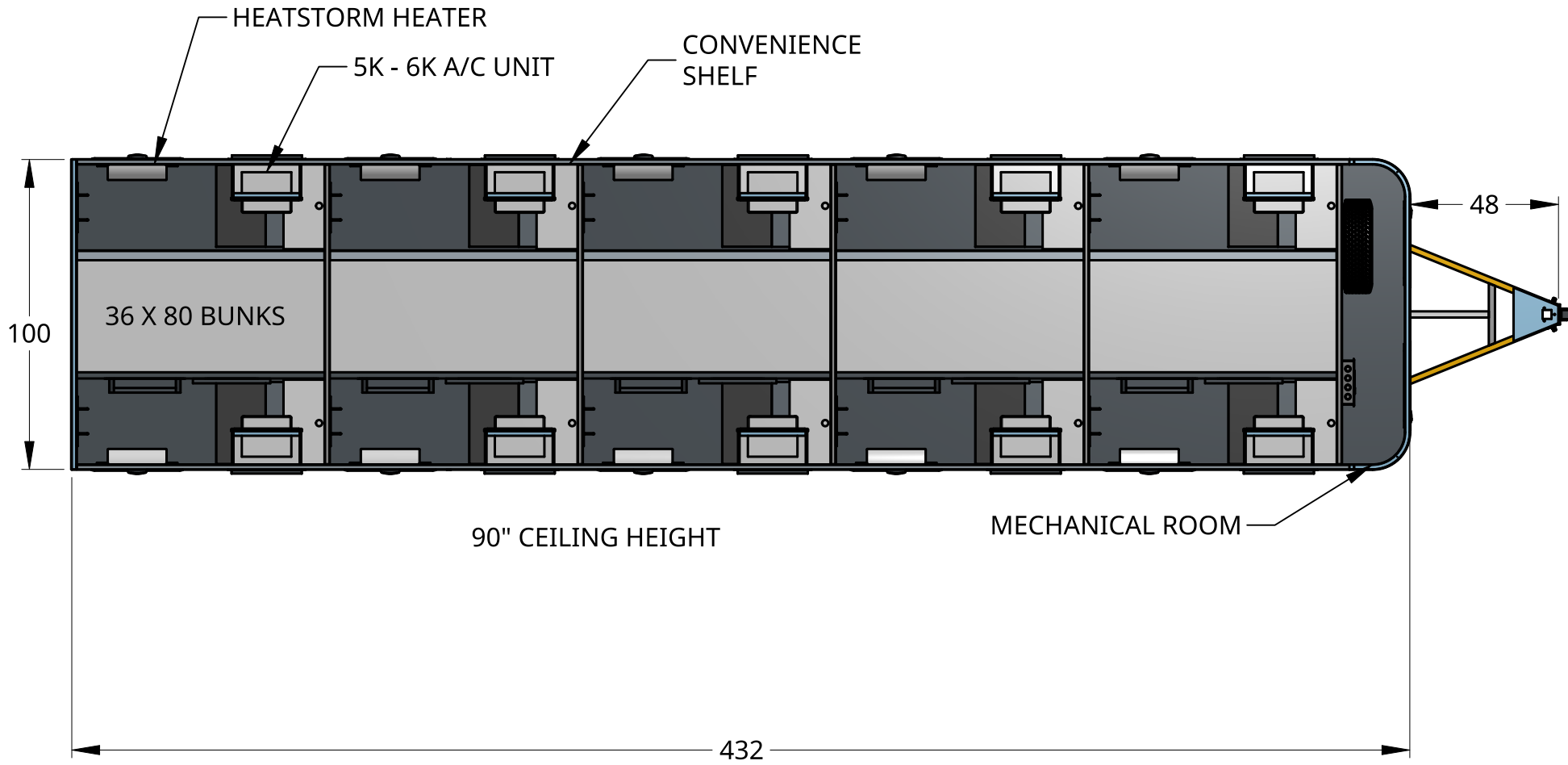

2

1

2

1

B

A

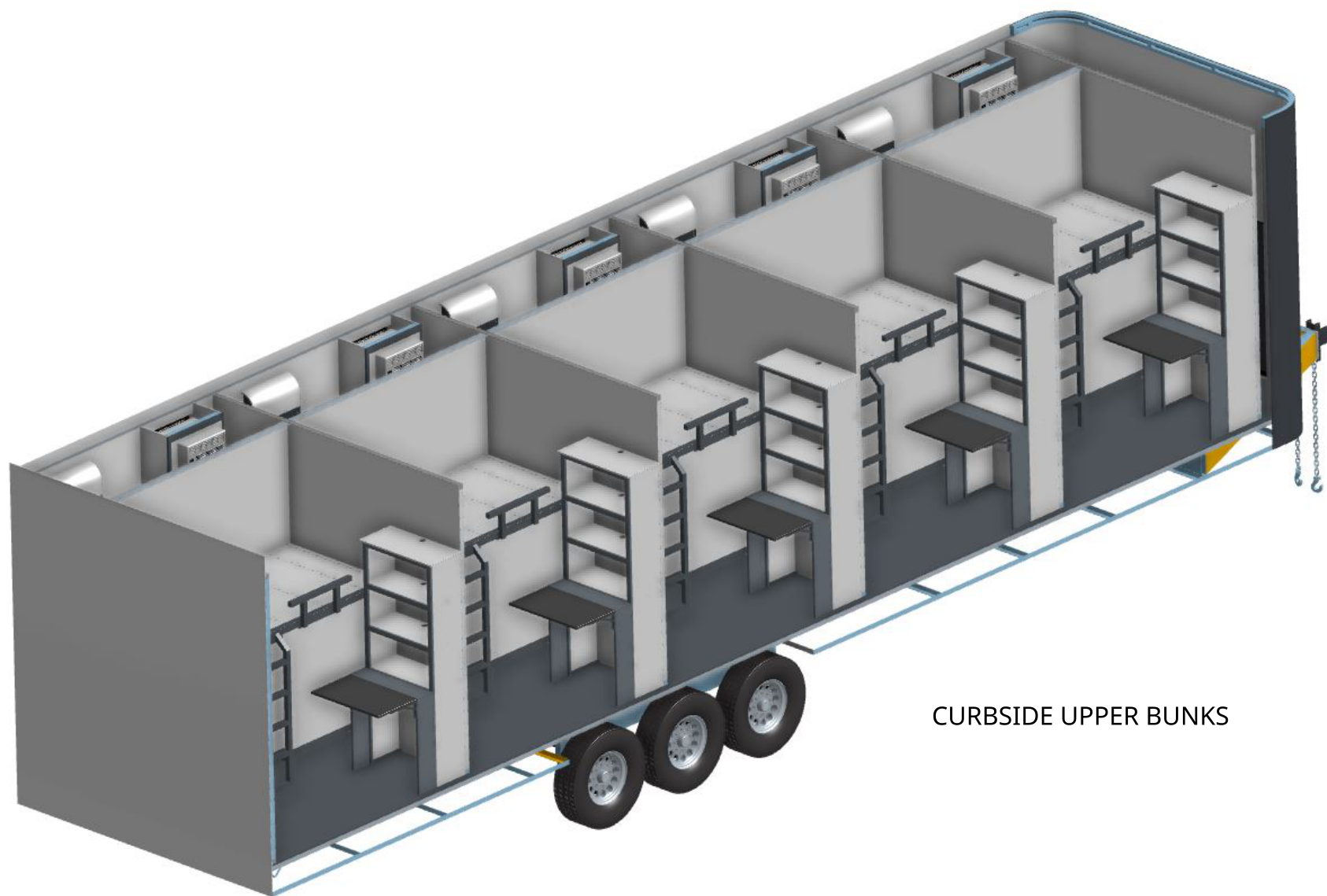

CURBSIDE UPPER BUNKS

2

1

DWG NO.	DRW-12596	SIZE	A	SCALE		SHEET	3 of 5	REV.	A
---------	-----------	------	---	-------	--	-------	--------	------	---

2

1

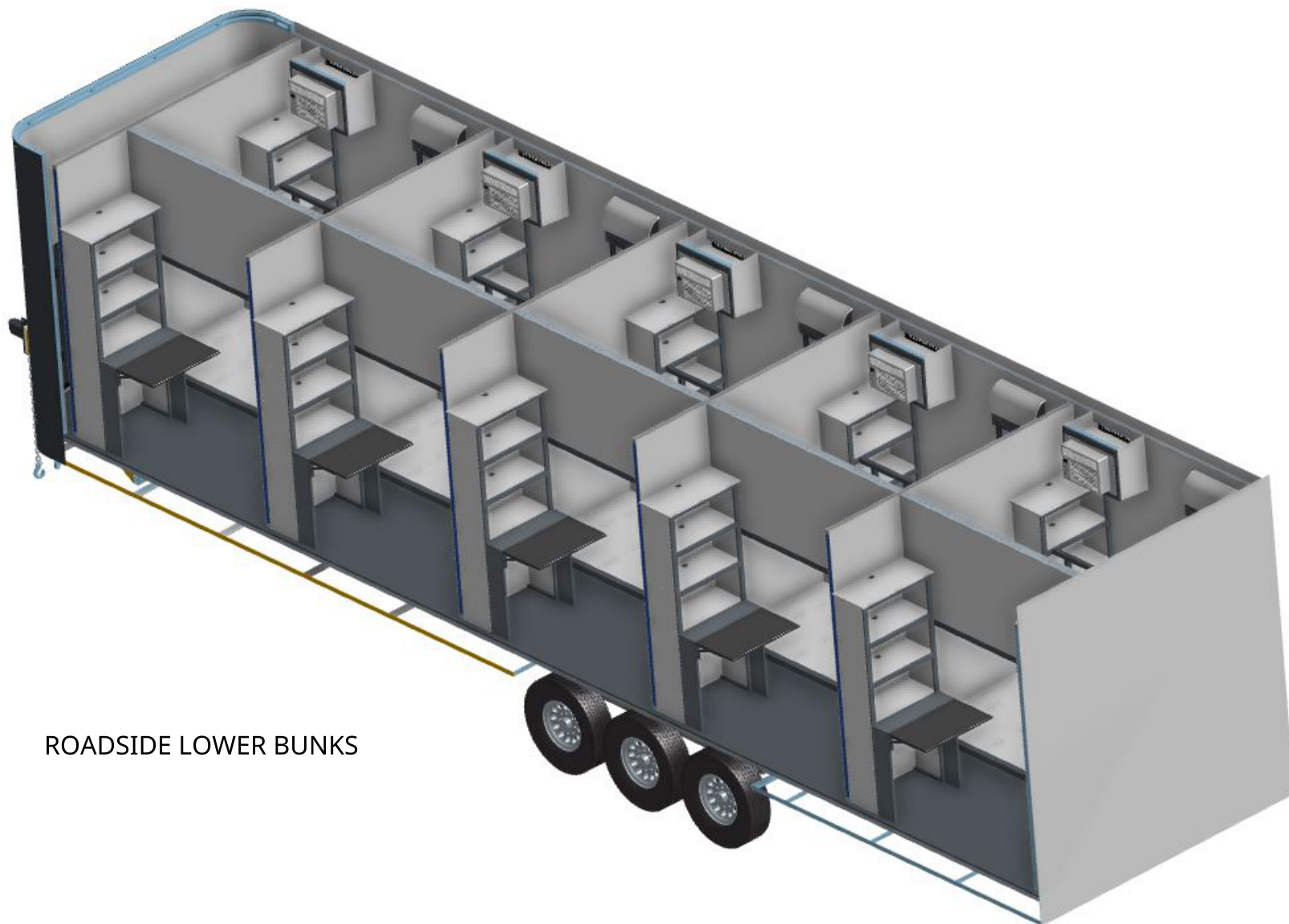

ROADSIDE LOWER BUNKS

2

1

2

1



DUAL CARGO
DOORS FOR
MECHANICAL
ROOM
ACCESS

2

1





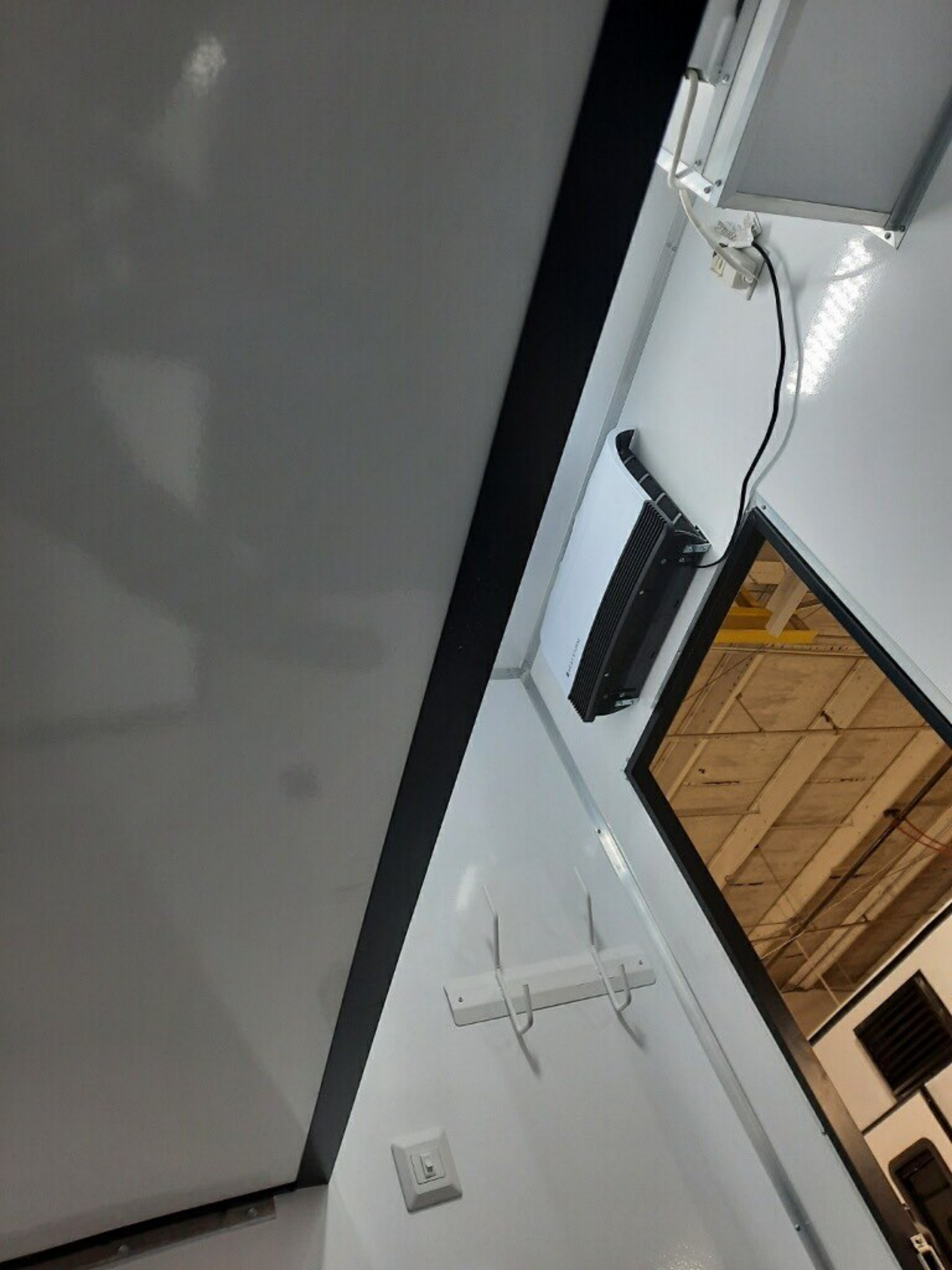



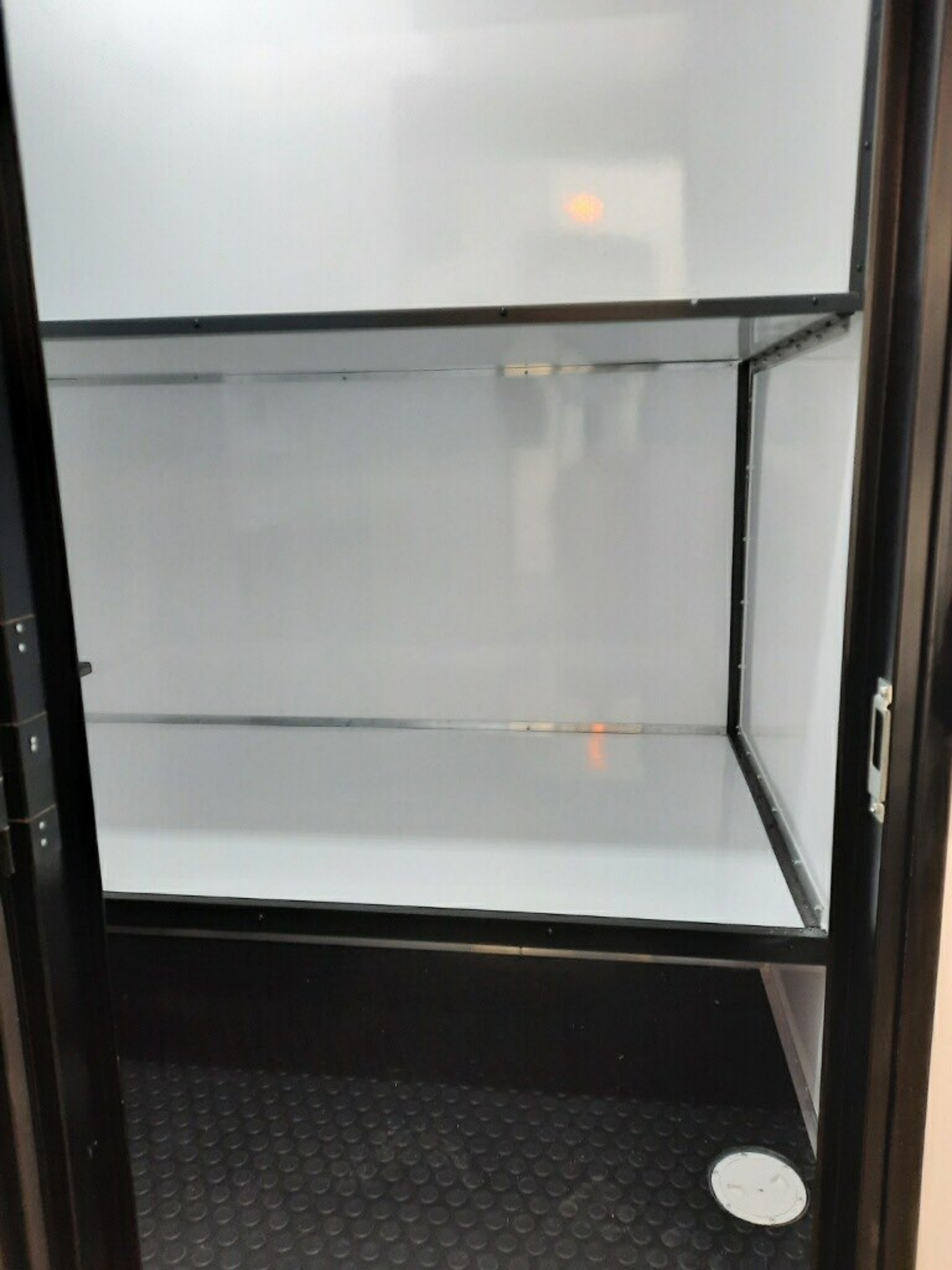



Pinnacle Hygienic Series Premium Mattress

from Derby Industries

- No inner springs - 2 solid foam core options
- Fire retardant - tested to stringent standards
- Derby's cover fabric acts as a virus barrier- anti-odor
- Cover will not crack - warranty against cracking
- Free patch kits available for accidental punctures

Standard single density foam core

Optional integrated memory foam topper provides added comfort



Proudly Made in the USA



www.derbyindustries.com

**Call today
toll free**

1.866.233.4500

Derby Industries

Pinnacle Hygienic Series Premium Mattress

**The ideal solution
for your firehouse**



- Comfortable, durable mattresses
- Perfect for hot bunking situations
- Easily cleaned and sanitized with a bleach solution
- Unlike many sewn mattresses, the Derby Pinnacle won't give bedbugs a place to hide!



100% Sealed Seams

- Zero stitching
- RF Welded seams combined with Derby's high performance cover material create a fluid resistant mattress that will not crack

