

# **RICHMOND FIELD ASSESSMENT**

**City Council Study Session  
Richmond, CA,  
September 26, 2023**

# RICHMOND FIELD ASSESSMENT

## PROJECT PURPOSE

Review of existing parks in Richmond to identify **upgrades to courts and fields** and locations for **soccer fields** for recreation, practice and competition





# RICHMOND FIELD ASSESSMENT

## BACKGROUND

In December 2010, the **Richmond Parks Master Plan** was adopted

*The Richmond Parks Master Plan is a **strategic document** that provides long-term vision for the City's parks, trails and open space.*

*The plan sets the **level of service standards** for park acreage, service areas and active sport and recreation facilities per capita.*

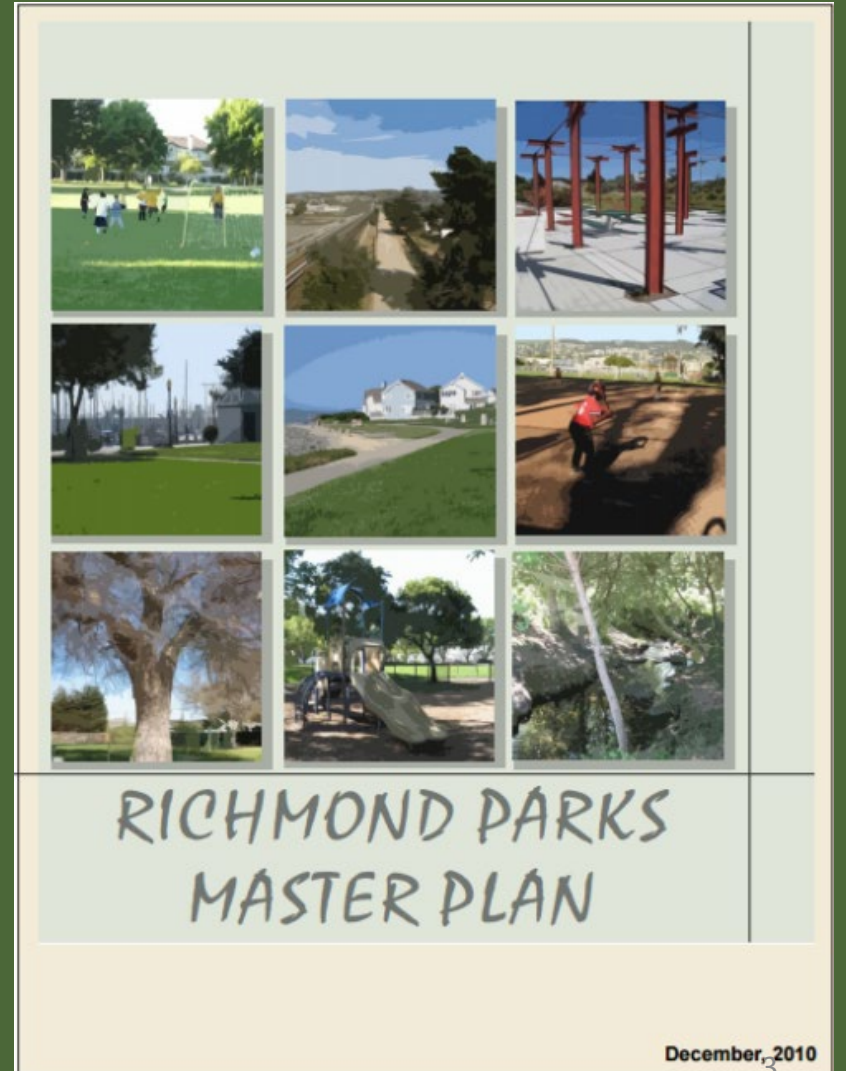

# RICHMOND FIELD ASSESSMENT

## BACKGROUND

### RICHMOND PARKS:

Richmond has

**50 City Parks – 247.6 acres**

**7 Joint Use Sites – 30.7 acres**

**278.3 acres of park land including joint use sites**

**7 Regional Parks – 5,225 acres**

**1 National Historical Park**





# RICHMOND FIELD ASSESSMENT

## BACKGROUND

### POPULATION:

2010 Population Estimate was 105,630 residents, and in 2020, **116,448**

- **26%** of the population is under the age of 18 years, and
- **14%** of the population is 65 years of age or older.

**Children, youth and seniors constitute significant segments of Richmond's population.**

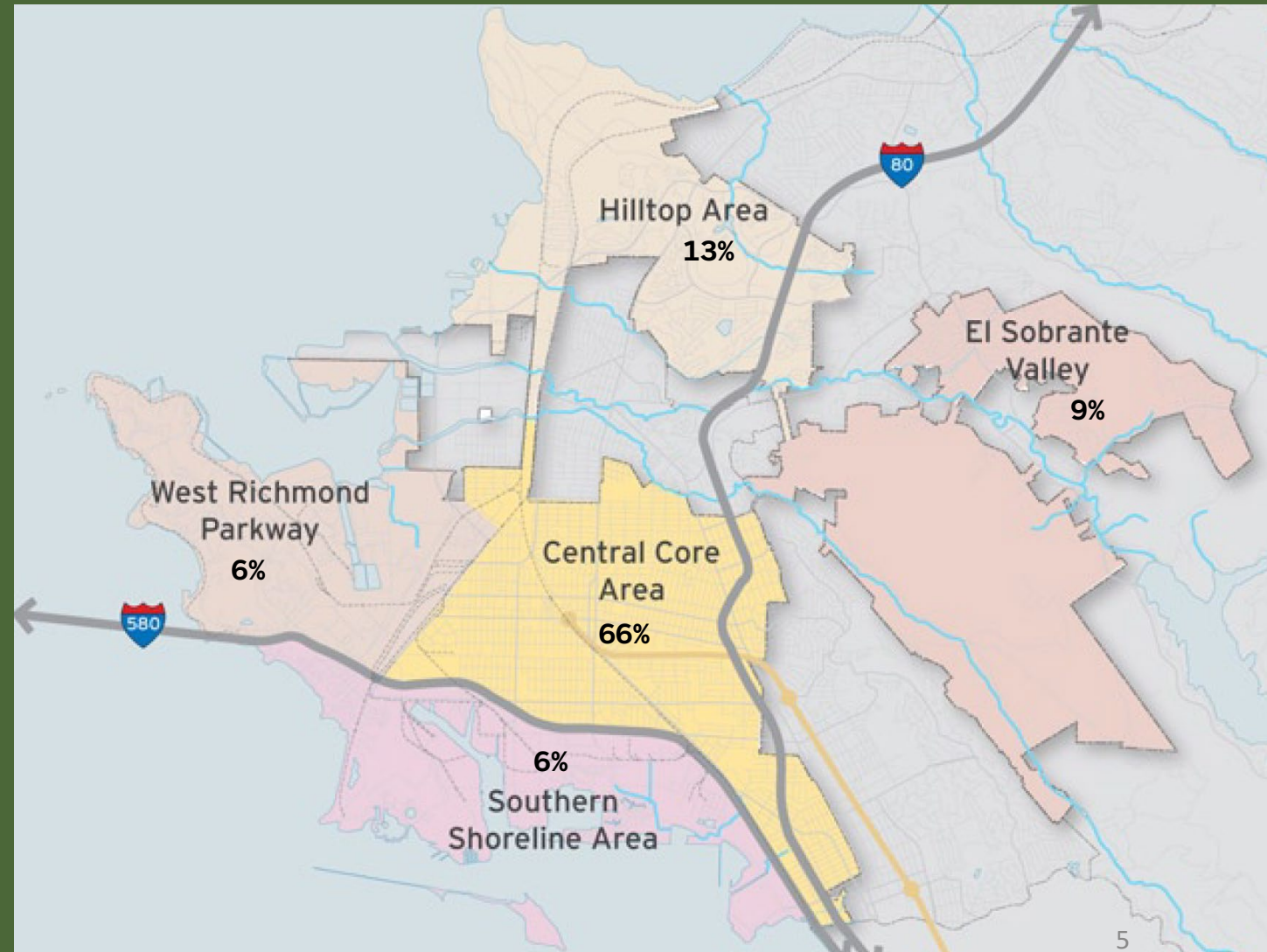

# RICHMOND FIELD ASSESSMENT

## BACKGROUND

### SOCCER LEVEL OF SERVICE:

According to the City of Richmond 2010 Parks Master Plan, there is to be **1 soccer field per 3,000 residents**.

Thus, the City should have **23 fields** based upon the City's current population.





# RICHMOND FIELD ASSESSMENT

## BACKGROUND

Richmond has a robust group of soccer clubs with **38-40 teams**

- Richmond SOL
- Richmond Rayados
- Richmond United Soccer Club

The soccer community **plays year-round** with a short break of 2-3 weeks in December

*Additional clubs include Albany Berkeley Soccer Club, West Contra Costa Youth Soccer League, Eastshore Alliance*



# RICHMOND FIELD ASSESSMENT

## BACKGROUND

The soccer clubs currently practice and play at:

- Tom Bates Regional Sports Complex
- Martin Luther King, Jr. Park
- Booker T. Anderson Park
- Country Club Vista Park
- Shields-Reid Park
- Nichol Park
- Wendell Park

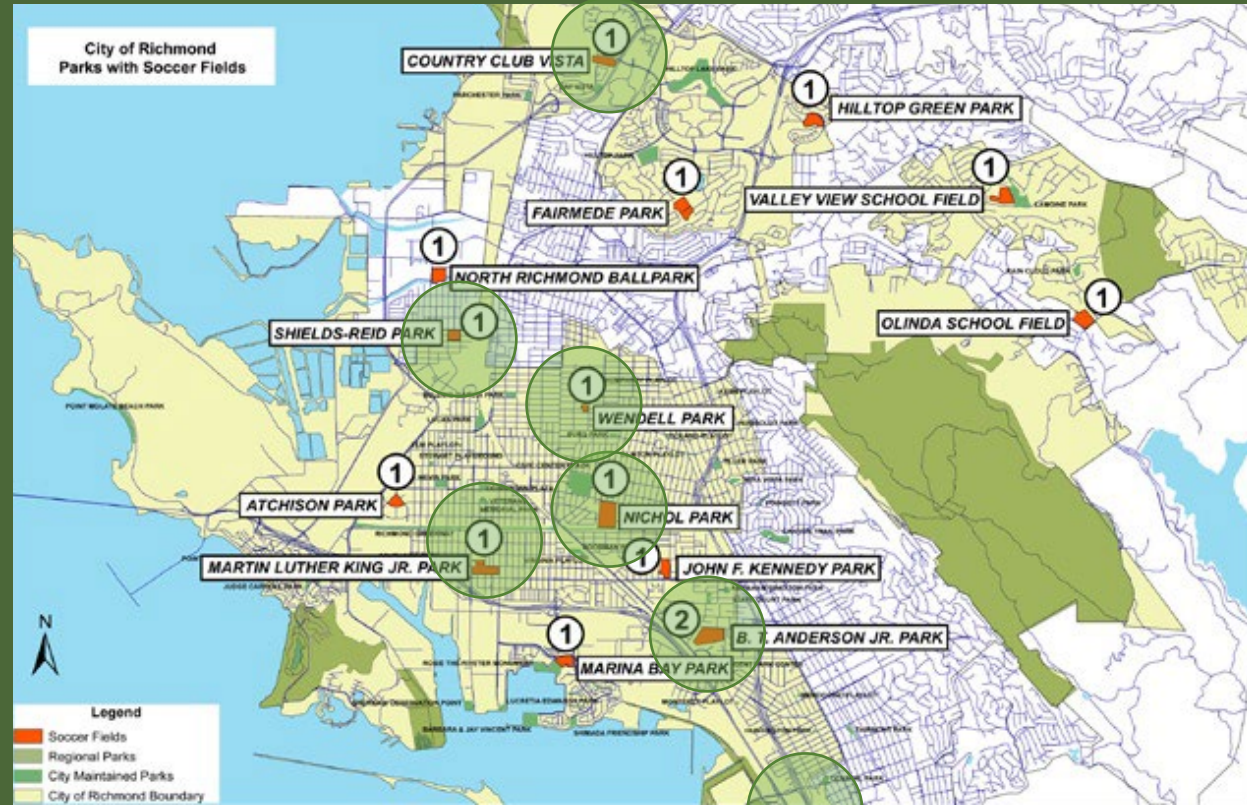



# RICHMOND FIELD ASSESSMENT

## BACKGROUND

### BASEBALL, SOFTBALL AND FOOTBALL LEVEL OF SERVICE:

According to the City of Richmond 2010 Parks Master Plan, there is to be 1 field per 4,400 residents for softball and baseball and 1 to 26,000 for football.

- **Baseball** – 13 baseball fields existing
- **Softball** – have 11 fields existing, need two more fields
- **Football** – 4 fields, need one more field



# RICHMOND FIELD ASSESSMENT

## BACKGROUND

Richmond has a multiple baseball, softball and football teams

- **Richmond Little League** – 12 teams
- **City and Richmond Police Athletic League Flag Football** – 12 teams
- **Junior Giants Baseball and Softball** – 22 teams
- **Richmond Steelers** – 6-7 teams
- **East Bay Cyclones** – 16 teams



Little League





# RICHMOND FIELD ASSESSMENT

## BACKGROUND

The **baseball, softball** and **football** clubs currently practice and play year-round with the exception of later November to early January at:

- Booker T. Anderson Park
- Nichol Park
- Richard Boyd Park
- Belding-Garcia Park
- North Richmond Ball Fields
- Tiller Park

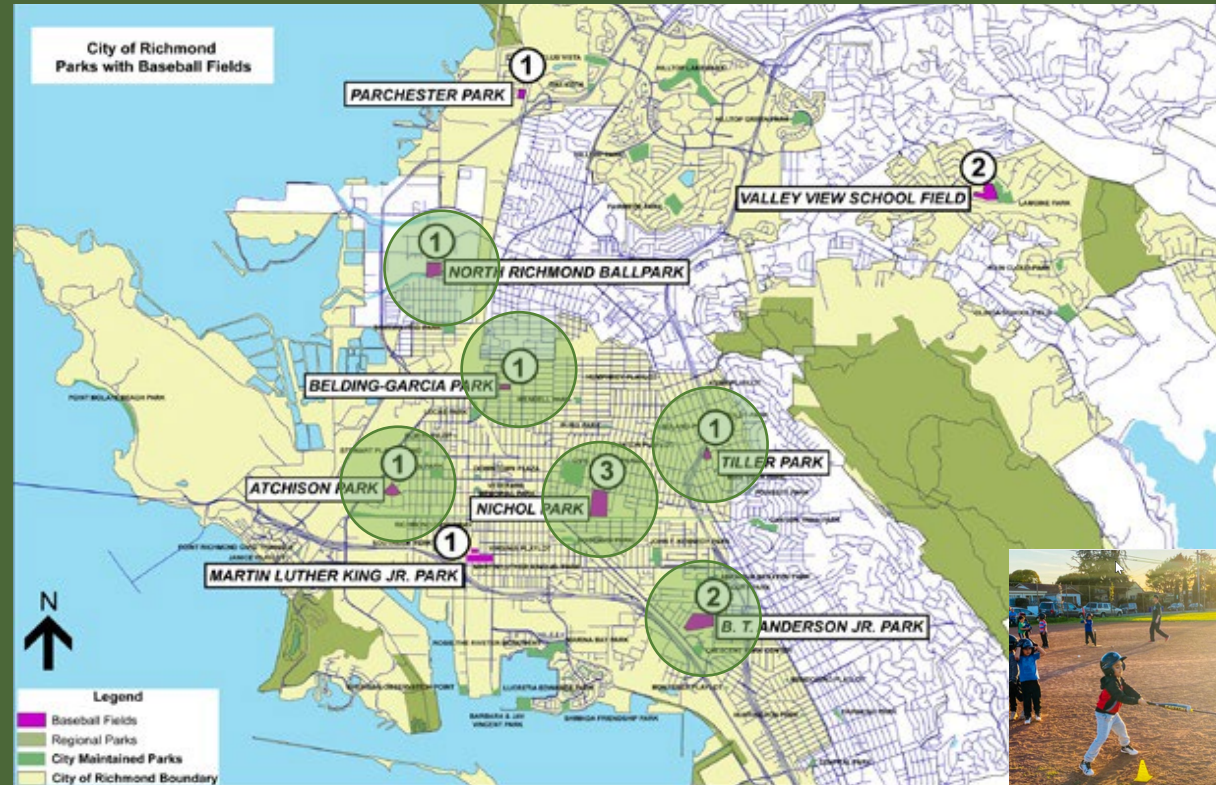



# RICHMOND FIELD ASSESSMENT

## FINDINGS

To support the club and league play we need fields with:

- **Parking** with accessible path of travel
- **Restrooms**, concessions and drinking fountains
- **Spectator area and seating**
- **Fencing**
- **Play area** for non-participating siblings
- **Storage** for goals and equipment
- **Lighting** for evening play





# RICHMOND FIELD ASSESSMENT

## FINDINGS

Richmond Soccer groups need two field sizes

- **U10 / 7v7** – for practice and matches for 10-years old and under
- **U13 / 11v11** – for players 13- to 18-years old and above
- Recommend Number of Fields
  - **6-10 U13 / 11v11** Fields
  - **13-17 U10 / 7v7** Fields



# RICHMOND FIELD ASSESSMENT

## FINDINGS

**U10 / 7 v 7** – for practice and matches for 10 years old and under

Length (touchline)	55-65 yards
Width (goal line)	35-45 yards
Center Circle Diameter	16 yards
Goal Area Dimensions	4 x 8 yards
Goal Size high	18 feet wide x 6 ft.





# RICHMOND FIELD ASSESSMENT

## FINDINGS

**U13 / 11 v 11** – for players 13 to 18 years old and above

Length (touchline)	100-120 yards
Width (goal line)	50-80 yards
Center Circle Diameter	20 yards
Goal Area Dimensions	6 x 20 yards
Goal Size high	18 feet wide x 6 ft.



# RICHMOND FIELD ASSESSMENT

## RICHMOND PARKS

There are **18-20** Richmond parks that may accommodate U10/7v7 and U13/11v11 soccer fields of varying size within the six City Council Districts plus **WCCUSD joint use sites**

- **17 Neighborhood Parks**
- **3 Community Parks**
- **4-6 WCCUSD Joint Use Site**

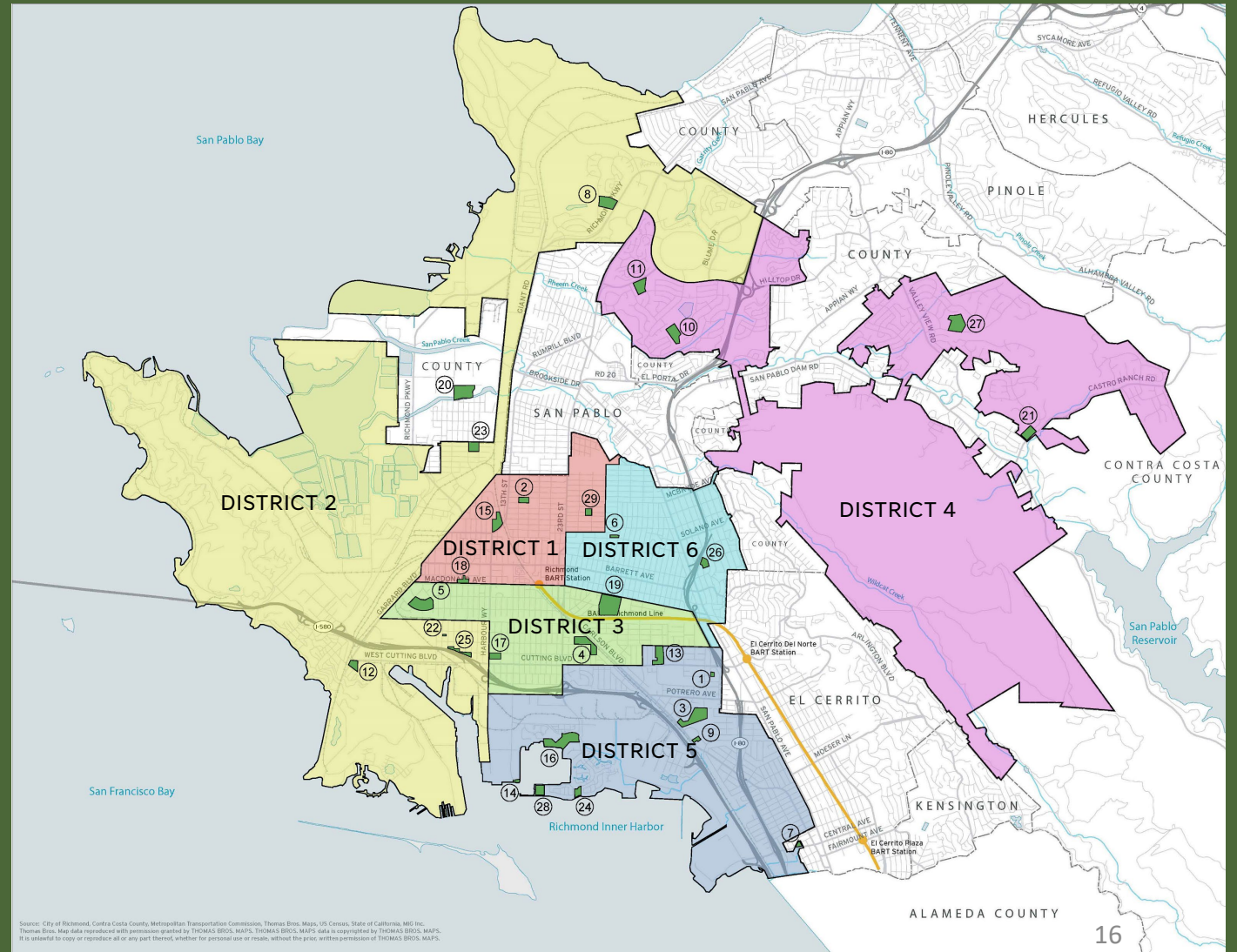



# RICHMOND FIELD ASSESSMENT

## RICHMOND PARKS

### DISTRICT 1

- **Belding Garcia Park** – (1) U10
- **Lucas Park** – (1) U13, (1) recreational field
- **Nevin Park** – (1) U10 or smaller U8 field
- **Wendell Park** – (1) U13

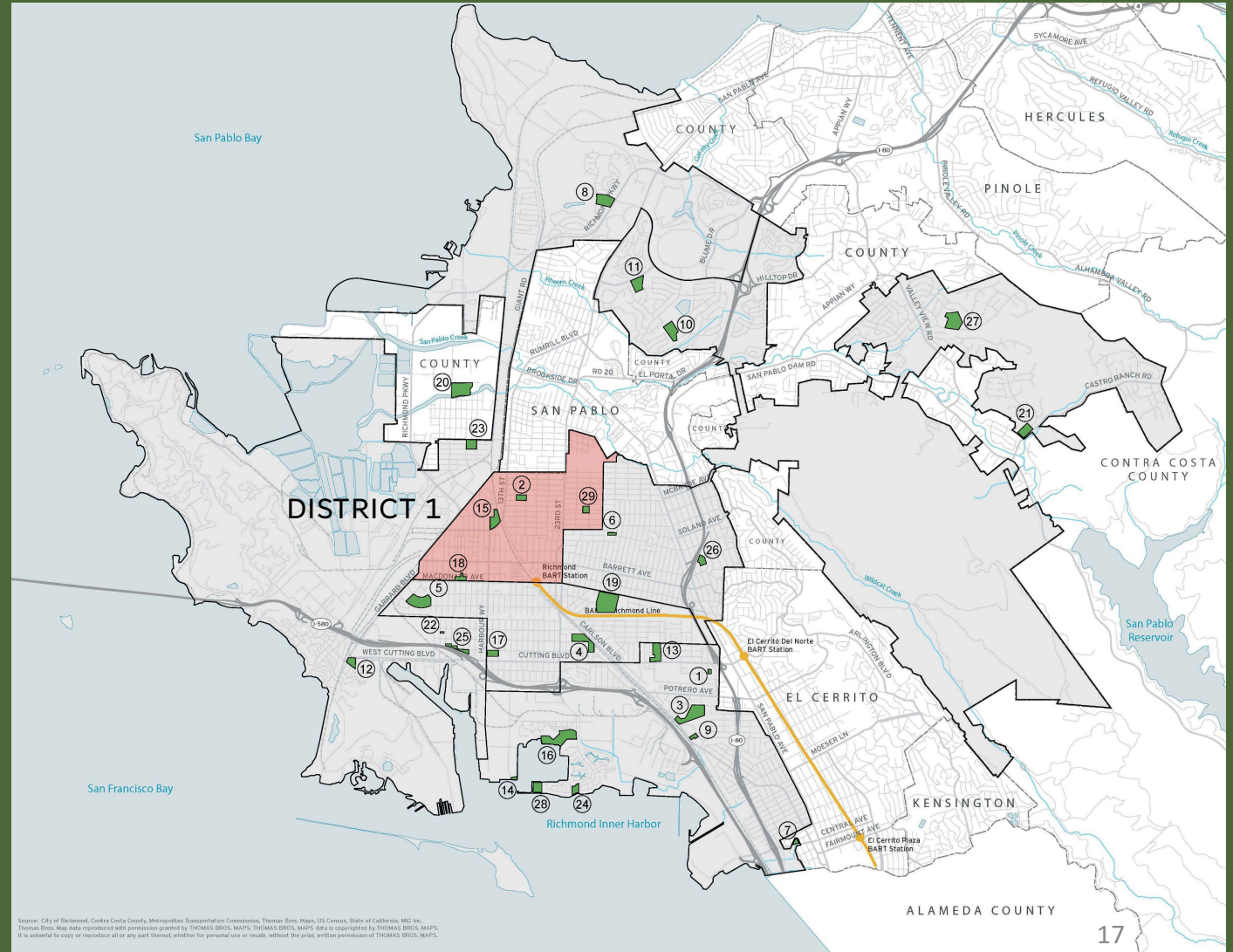

# RICHMOND FIELD ASSESSMENT

## RICHMOND PARKS

### DISTRICT 1

- Belding Garcia Park – (1) U10
- Lucas Park – (1) U10, (1)U13
- Nevin Park – (1) U10
- Wendell Park – (1) U13



Belding-Garcia Park



Lucas Park



Nevin Park



Wendell Park



# RICHMOND FIELD ASSESSMENT

## RICHMOND PARKS

### DISTRICT 2

- **Country Club Vista Park** – (1) U13 and (1) U10
- **Judge Carroll Park** – (1) U10 conflict with informal dog park use
- **North Richmond Ball Field** – (1) U13
- **Shields-Reid Park** – (1) U13 plan exists to upgrade the field

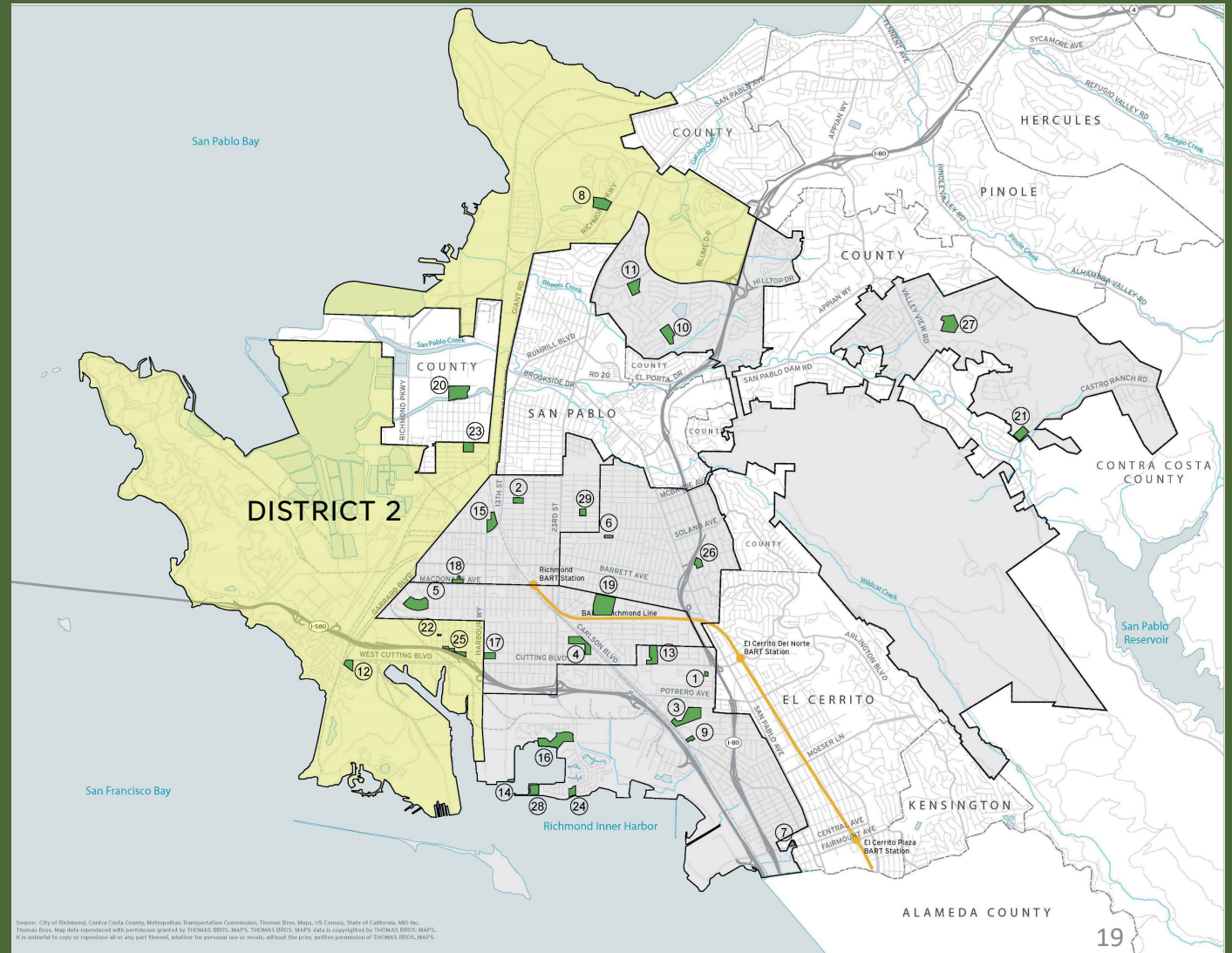

# RICHMOND FIELD ASSESSMENT

## RICHMOND PARKS

### DISTRICT 2

- **Country Club Vista Park** – (1) U10 and (1) U103
- **Judge Carroll Park** – (1) U10 conflict with informal dog park use
- **North Richmond Ball Field** – (1) U13
- **Shields-Reid Park** – (1) U13 plan exists to upgrade the field



Country Club Vista Park



Judge Carroll Park

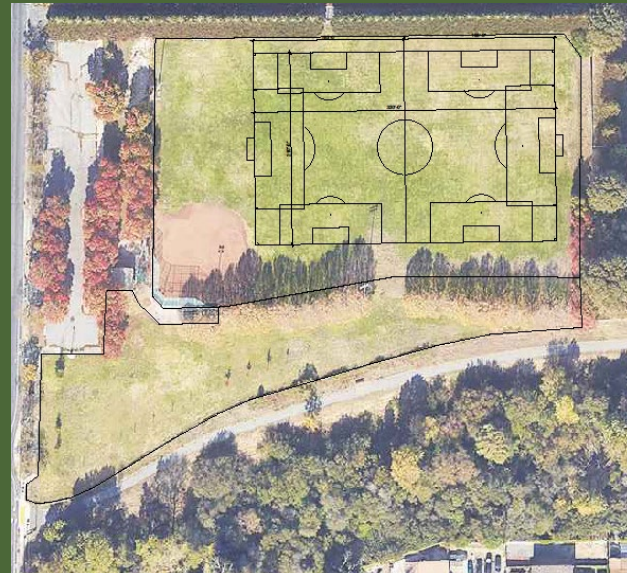

North Richmond Ball Field



Shields-Reid Park



# RICHMOND FIELD ASSESSMENT

## RICHMOND PARKS

### DISTRICT 2

- Shields-Reid Park – (1) U13 plan exists to upgrade the field

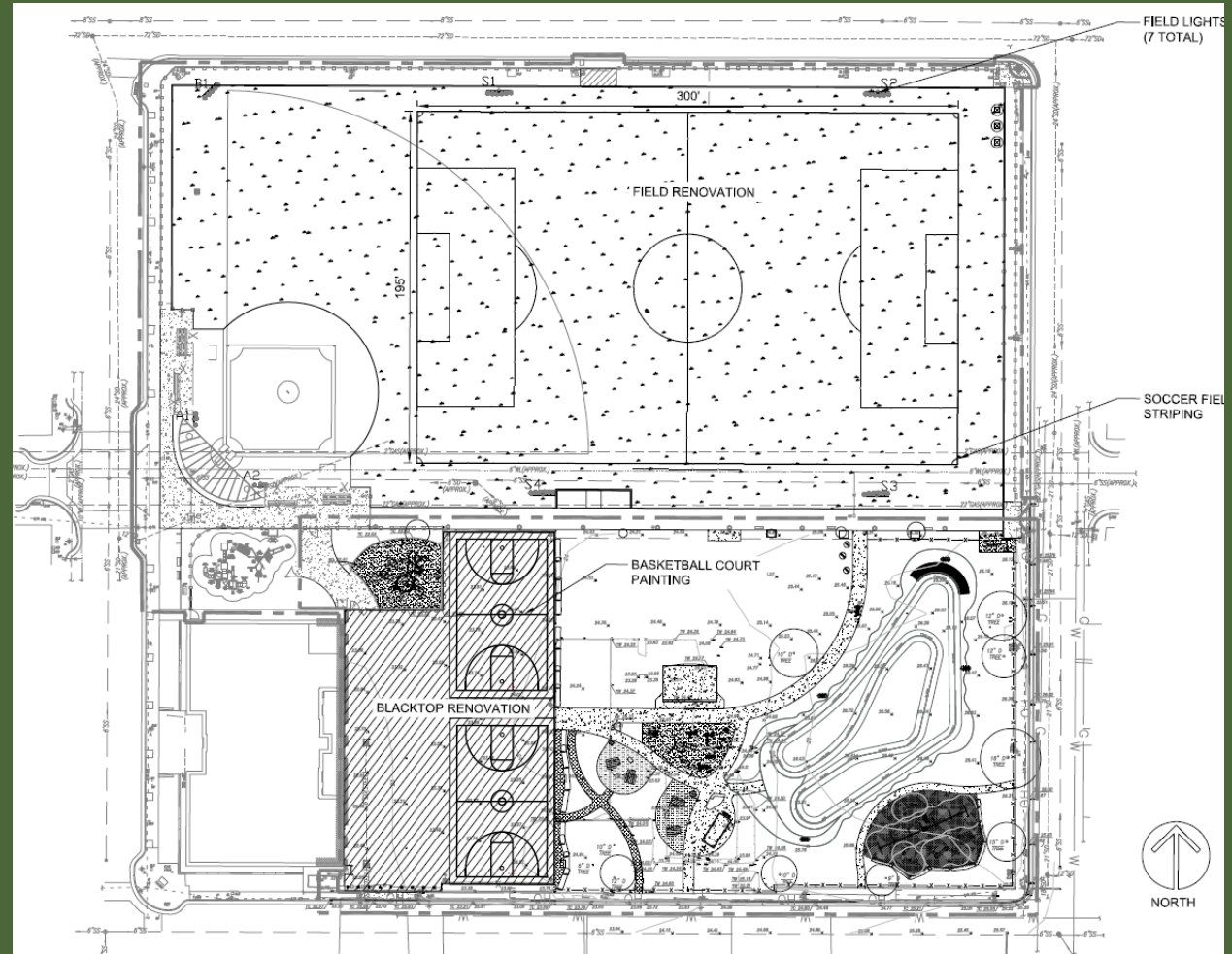

Shields-Reid Park

# RICHMOND FIELD ASSESSMENT

## RICHMOND PARKS

### DISTRICT 3

- **Boorman Park** – (1) U10 Currently funded by Prop 84 Grant
- **Boyd Park** – (1) U10, Applied for grant 2023
- **Martin Luther King, Jr. Park** – (2) U13, including existing artificial turf fields
- **Nichol Park** – (2) U13, (2)U10
- **Unity Park Phase II** – (1) U10, Applied for grant 2023

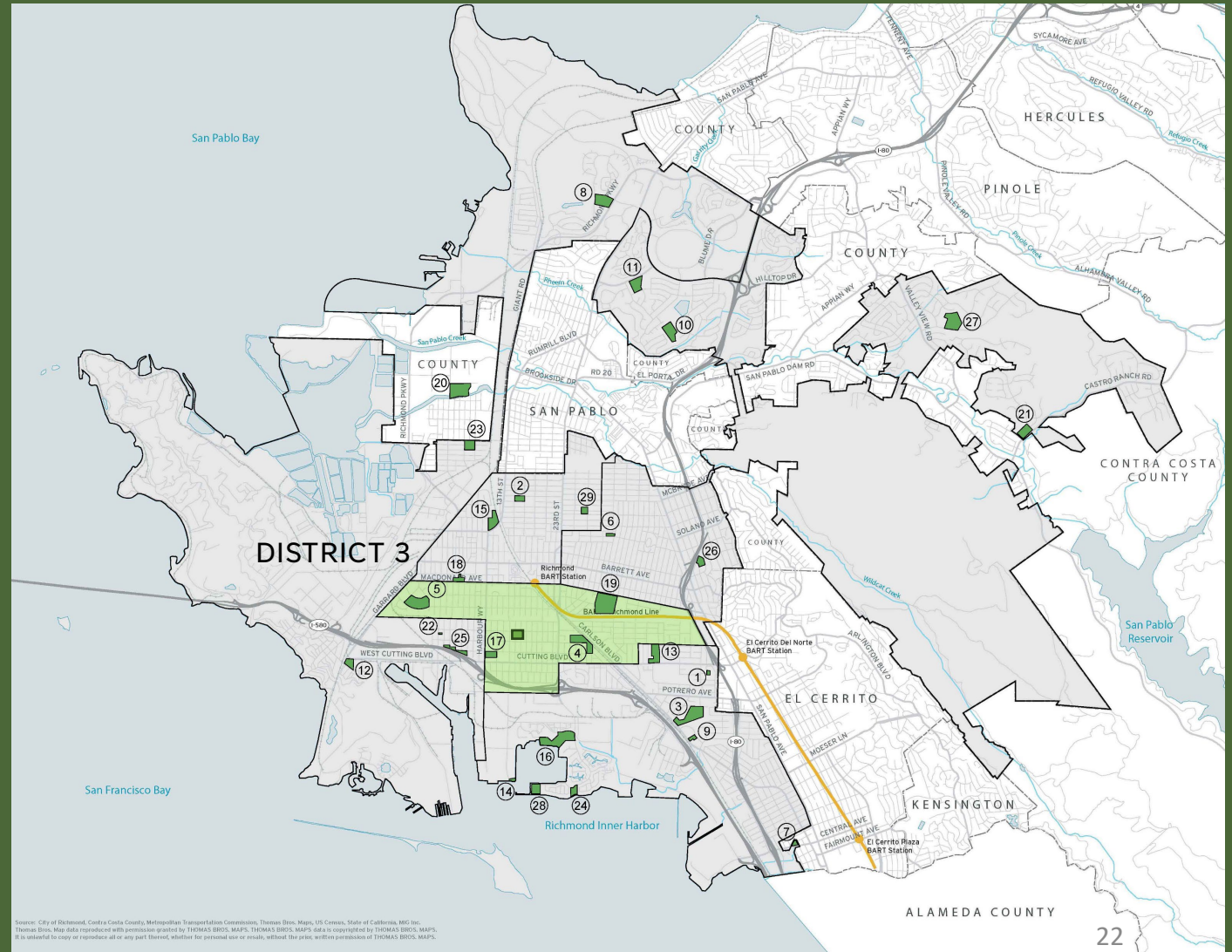



# RICHMOND FIELD ASSESSMENT

## RICHMOND PARKS

### DISTRICT 3

- **Boorman Park** – (1) U10, Currently funded by Prop 84 Grant
- **Boyd Park** – (1) U13, Applied for Clean California Grant 2023
- **Lavonya DeJean Middle School** – (1) U13, Joint Use Site
- **Martin Luther King, Jr. Park** – (2) U13, including existing artificial turf fields
- **Nichol Park** – (2) U13, (2)U10
- **Unity Park Phase II** – (1) U10, Applied for Clean California Grant 2023

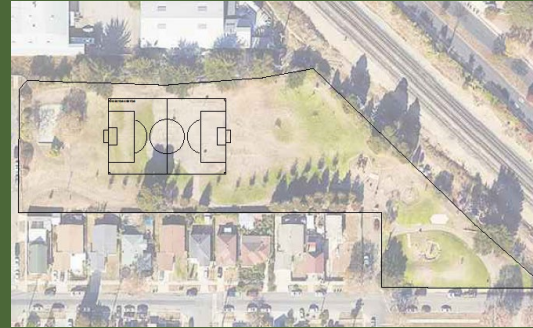

Boorman Park



Richard J. Boyd Park



Nichol Park



Lavonya DeJean Middle School



Unity Park – Phase II

Martin Luther King, Jr. Park



# RICHMOND FIELD ASSESSMENT

## RICHMOND PARKS

### DISTRICT 3

- **Boorman Park** – (1) U10 Currently funded by Prop 84 Grant
- **Boyd Park** – (1) U10, Applied for grant 2023
- **Unity Park Phase II** – (1) U10, Applied for grant 2023



Boorman Park



Richard J. Boyd Park



Unity Park – Phase II



# RICHMOND FIELD ASSESSMENT

## RICHMOND PARKS

### DISTRICT 3

- **Martin Luther King, Jr. Park** – Potential for combination artificial turf baseball/soccer field

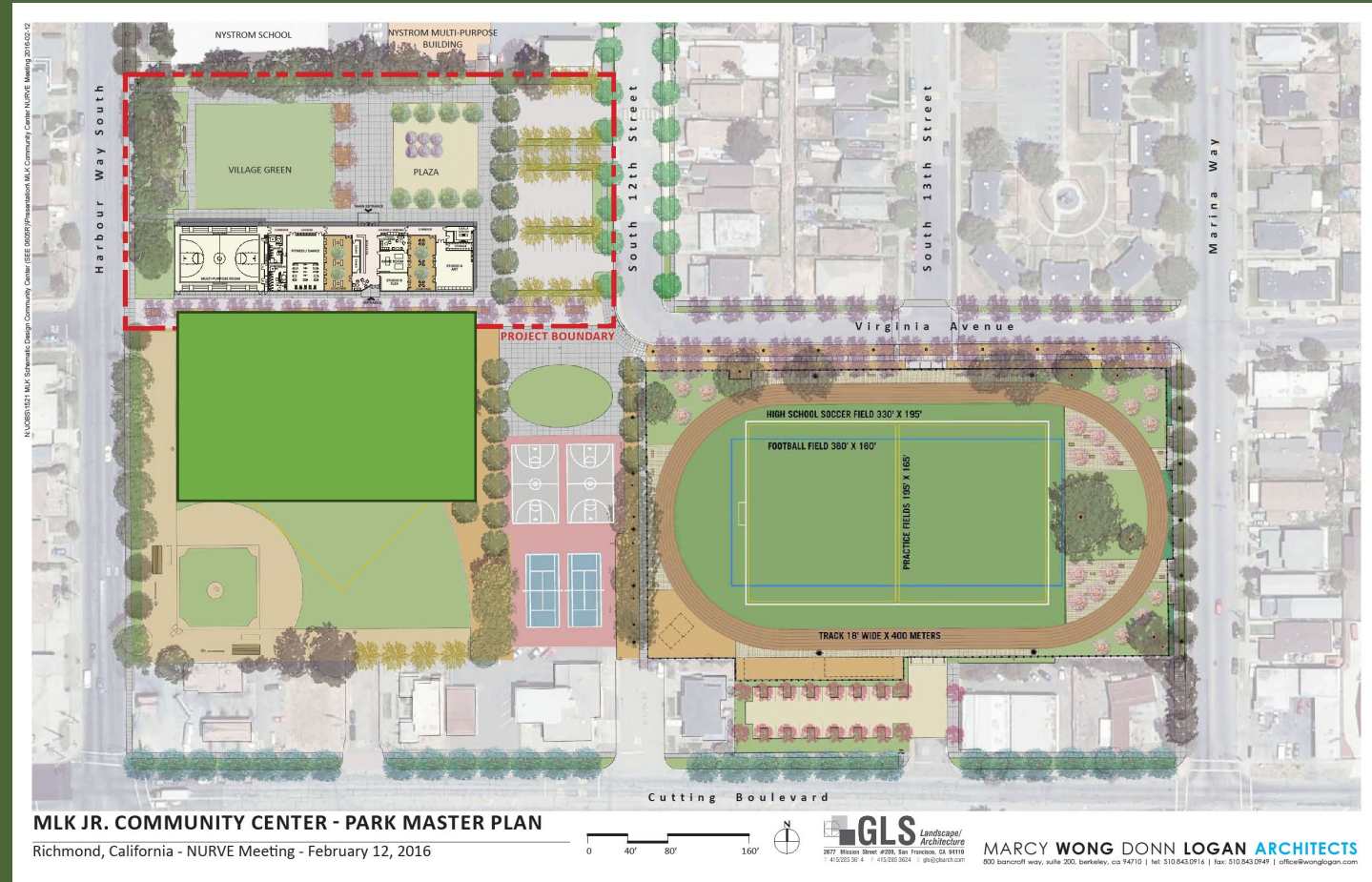

# RICHMOND FIELD ASSESSMENT

## RICHMOND PARKS

### DISTRICT 4

- **Fairmede Park at Highland Elementary School** – (1) U13, Joint Use Site
- **Hilltop Park** – (1) U10 – Joint Use Site
- **Olinda School Field** – (1) U13, Joint Use Site
- **LaMoine Park at Valley View School Field** – (1) U13, (1) U10, Joint Use

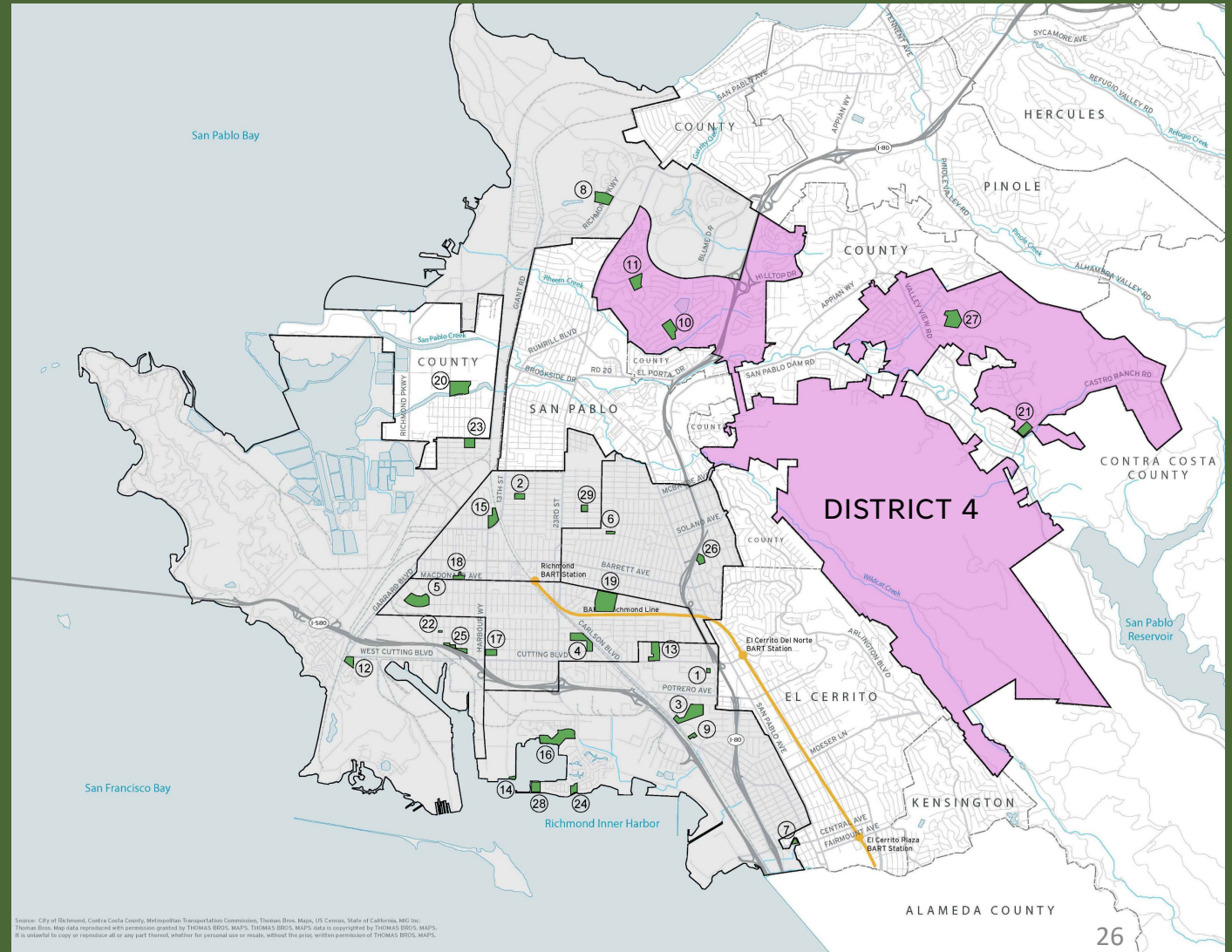



# RICHMOND FIELD ASSESSMENT

## RICHMOND PARKS

### DISTRICT 4

- **Fairmede Park at Highland Elementary School** – (1) U13, Joint Use Site
- **Hilltop Park** – (1)U10 – Joint Use Site
- **Olinda School Field** – (1)U13, Joint Use Site
- **LaMoine Park at Valley View School Field** – (1)U13, (2)U10, Joint Use



Fairmede Park at Highland School

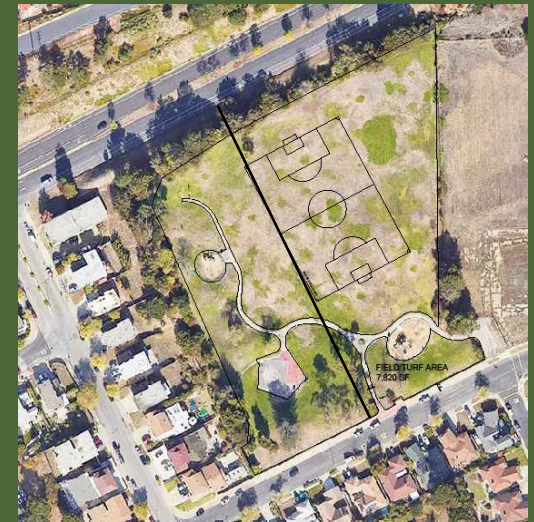

Hilltop Park



Olinda School Field



LaMoine Park at Valley View School



# RICHMOND FIELD ASSESSMENT

## RICHMOND PARKS

### DISTRICT 5

- **Booker T. Anderson Park** – (3-4)U13
- **John F. Kennedy Park** – (1) U13, (1)U10
- **Lucretia Edwards Park** – (1) Recreational
- **Marina Park** – (1) U13
- **Shimada Park** – (1) Recreational,
- **Vincent Park** – (1) Recreational
- **State Court Park at Kennedy High School** – (1)U13, Need Joint Use Agreement

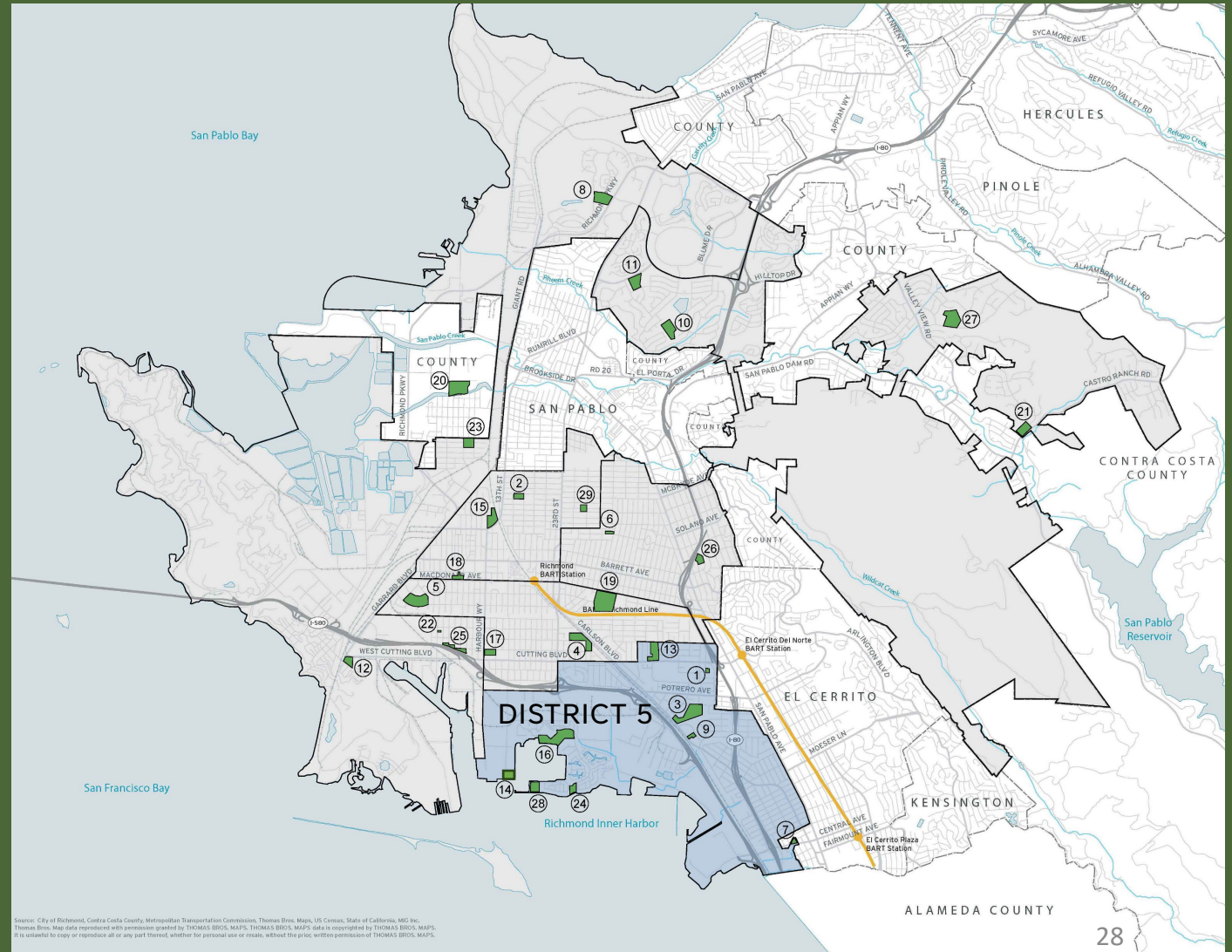



# RICHMOND FIELD ASSESSMENT

## RICHMOND PARKS

### DISTRICT 5

- **Booker T. Anderson Park** – (2) U13
- **Lucretia Edwards Park** – (1) Recreational, non-league/club play
- **John F. Kennedy Park** – (1) U13, (1)U10
- **State Court Park at Kennedy High School** – (2)U13, *Need Joint Use Agreement*
- **Vincent Park** – (1) Recreational, non-league/club play



Booker T. Anderson Park



Marina Park



Vincent Park



Lucretia Edwards Park



State Court Park at Kennedy High School



John F. Kennedy Park

# RICHMOND FIELD ASSESSMENT

## RICHMOND PARKS

### DISTRICT 6

- **Burg Park** – (1)U10
- **Tiller Park** – (1) Recreational, non-league/club play

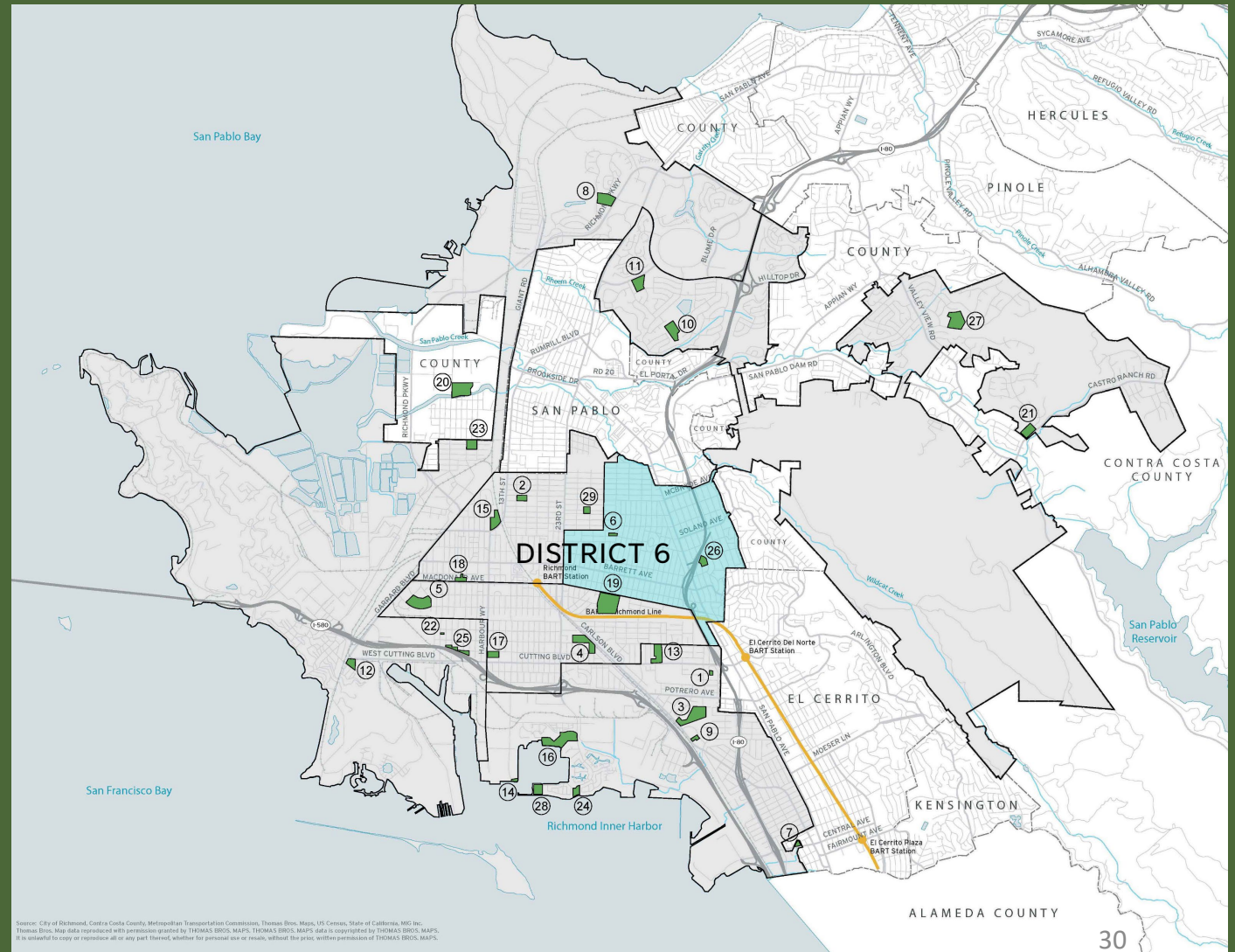



# RICHMOND FIELD ASSESSMENT

## RICHMOND PARKS

### DISTRICT 6

- **Burg Park** – (1) Recreational
- **Tiller Park** – (1) Recreational

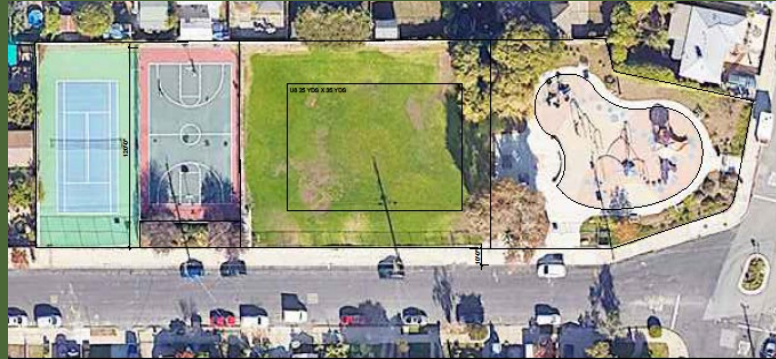

Burg Park



Tiller Park

# RICHMOND FIELD ASSESSMENT

## FIELD LOCATIONS

### U13 / 11v11 – 11 plus 5 joint use

- MLK – 1 turf, 1 grass
- Booker T. Anderson – 2 grass
- Wendell – 1 grass
- Country Club Vista – 1 grass
- North Richmond Fields – 1 grass
- Shields-Reid – 1 grass or turf
- Kennedy – 1 grass
- Marina Park – 1 grass
- Nichol – 1 grass
- Fairmede – 1 grass
- Valley View – 1 grass
- Olinda – 1 grass
- State Court – 2 grass

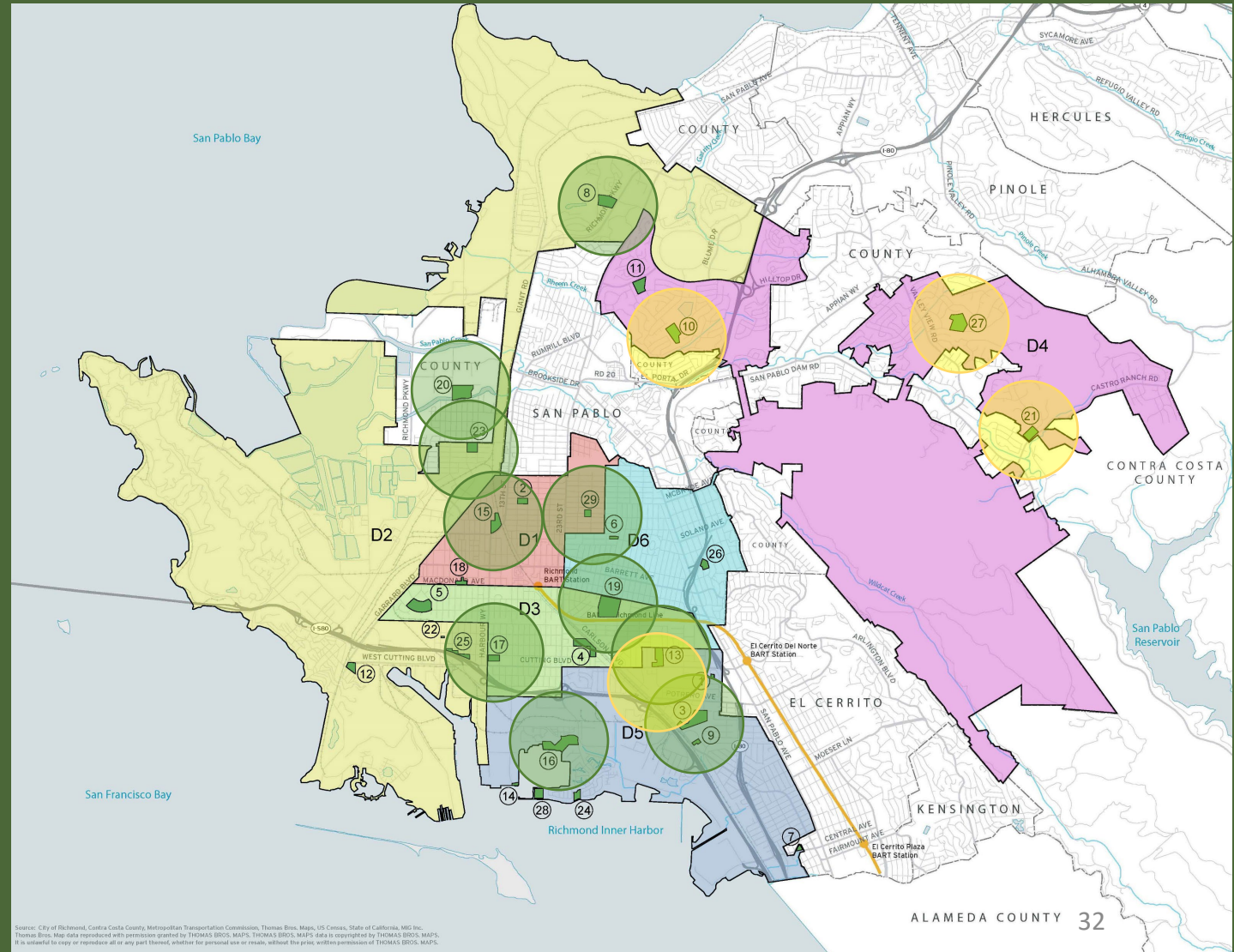



# RICHMOND FIELD ASSESSMENT

## FIELD LOCATIONS

**U10 / 7v7 – 7 plus 1 joint use and 4 recreational**

- Belding-Garcia – 1 grass
- Lucas Park – 1 grass
- Nevin – 1 grass
- Judge Carrol – 1 grass
- Boorman – 1 grass (turf)
- Boyd – 1 grass
- Unity – 1 turf (future)

- Hilltop – 1 grass
- Vincent – recreational
- Edwards – recreational
- Tiller – recreational
- Parchester – recreational

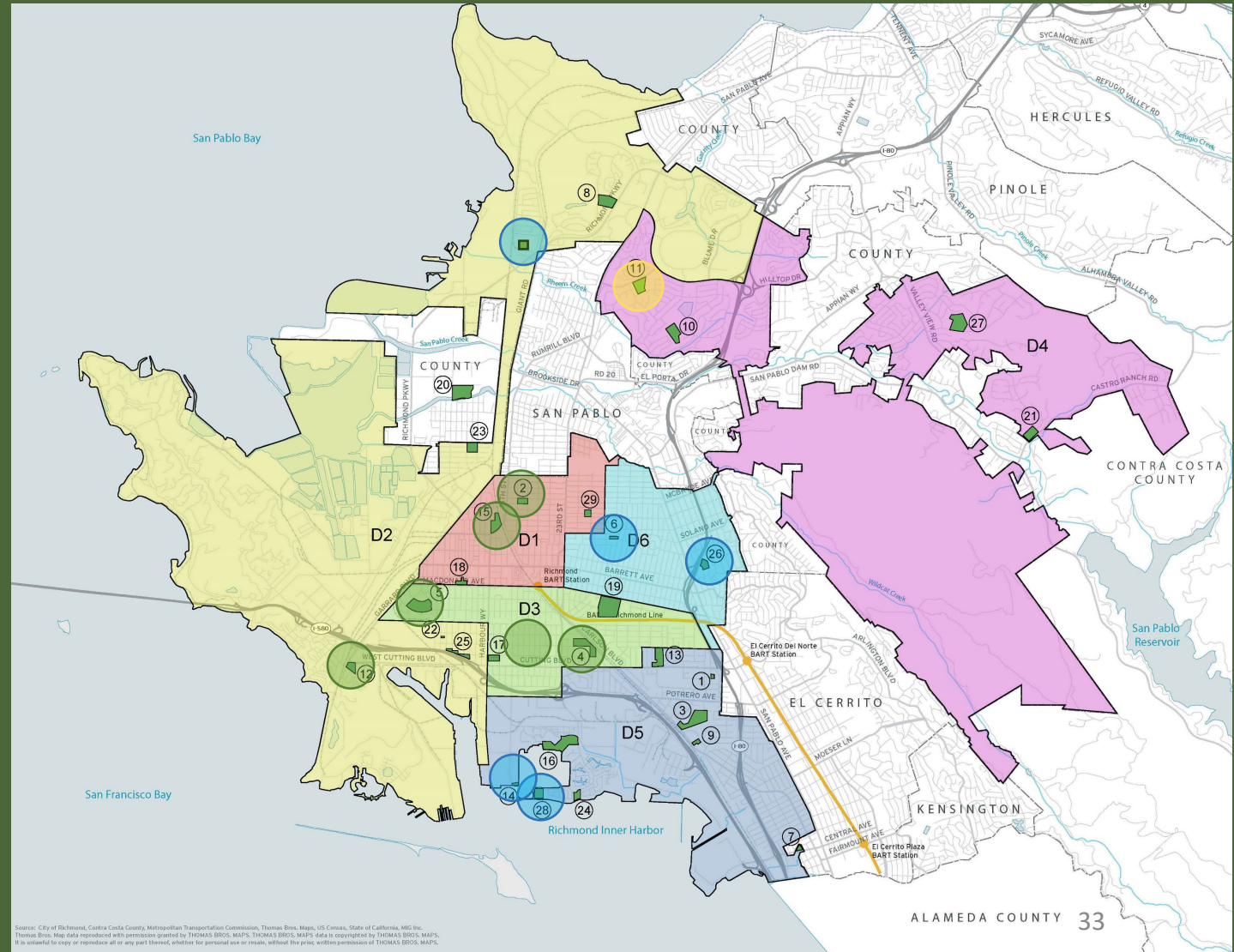

# RICHMOND FIELD ASSESSMENT

## RECOMMENDATIONS

### Expand useability of existing fields

- **Upgrade field areas** - grass, drainage, grades and irrigation
- **Upgrade amenities** – restrooms, play areas, parking, path of travel, fencing, tennis, basketball and pickle ball courts
- **Change configuration** and modify softball/baseball infields and fencing for multiuse
- **Obtain joint use agreements** with WCCUSD to expand field offerings in District 4





# RICHMOND FIELD ASSESSMENT

## RECOMMENDATIONS

### Create new competition fields

- Reconfigure large parks to accommodate more fields
- Install artificial turf to expand usage during rainy season
- Install or upgrade lighting to extend hours of use
- Create new community sports facilities

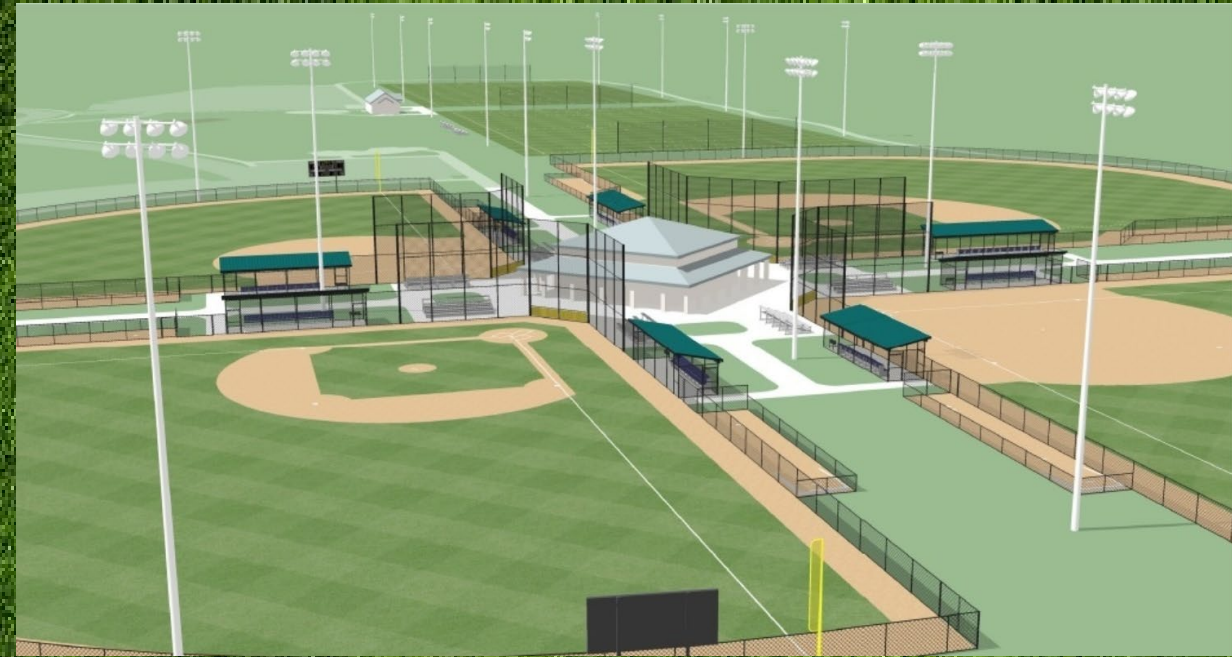

# RICHMOND FIELD ASSESSMENT

## IN THE WORKS

### DISTRICT 3

- **Boorman Park** – (1) U10 Currently funded by Prop 84 Grant
- **Boyd Park** – (1) U13, Applied for grant 2023
- **Unity Park Phase II** – (1) U10, Applied for grant 2023



Boorman Park



Richard J. Boyd Park



Unity Park – Phase II



# RICHMOND FIELD ASSESSMENT

## SHORT TERM PLAY

- **Wendell Park** – upgrade irrigation, refurbish turf, replace fencing and backstop, fence futsal court, renovate play area
- **Shields-Reid Park** – fund artificial turf field
- **Maintenance** – Increase maintenance budget to renovate and maintain existing turf areas
- **Adopt-A-Spot** maintenance assistance by leagues and clubs to help maintain fields during seasonal play

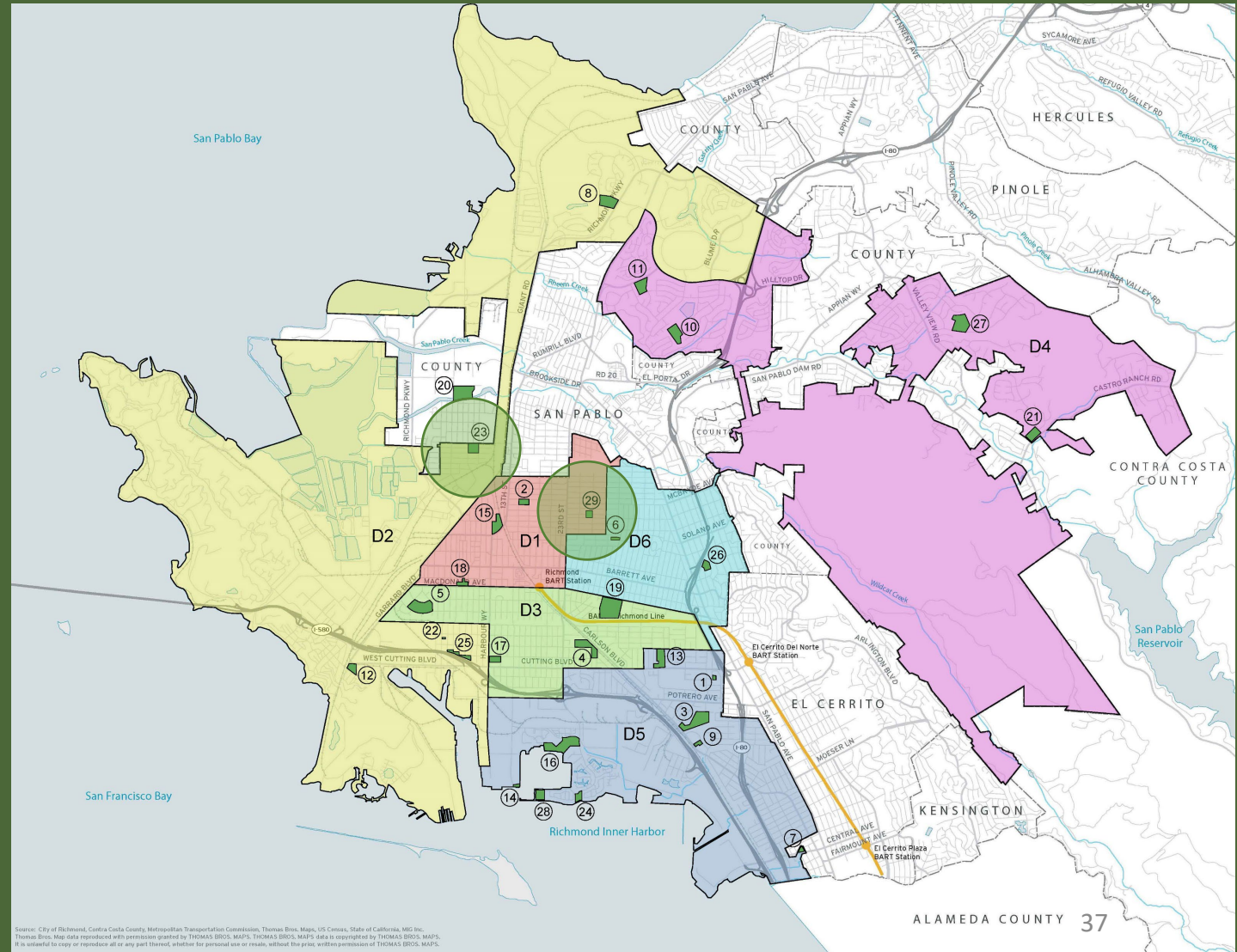

# RICHMOND FIELD ASSESSMENT

## MID TERM PLAY

- **Country Club Vista** – install artificial turf within soccer area, install new restroom building, and field lighting
- **North Richmond Fields** – reconfigure and install artificial turf, restrooms, play area, fencing modifications, reconfigure parking and add field lighting. Possible joint use agreement with WCCUSD at Verde School for basketball courts on hard court area

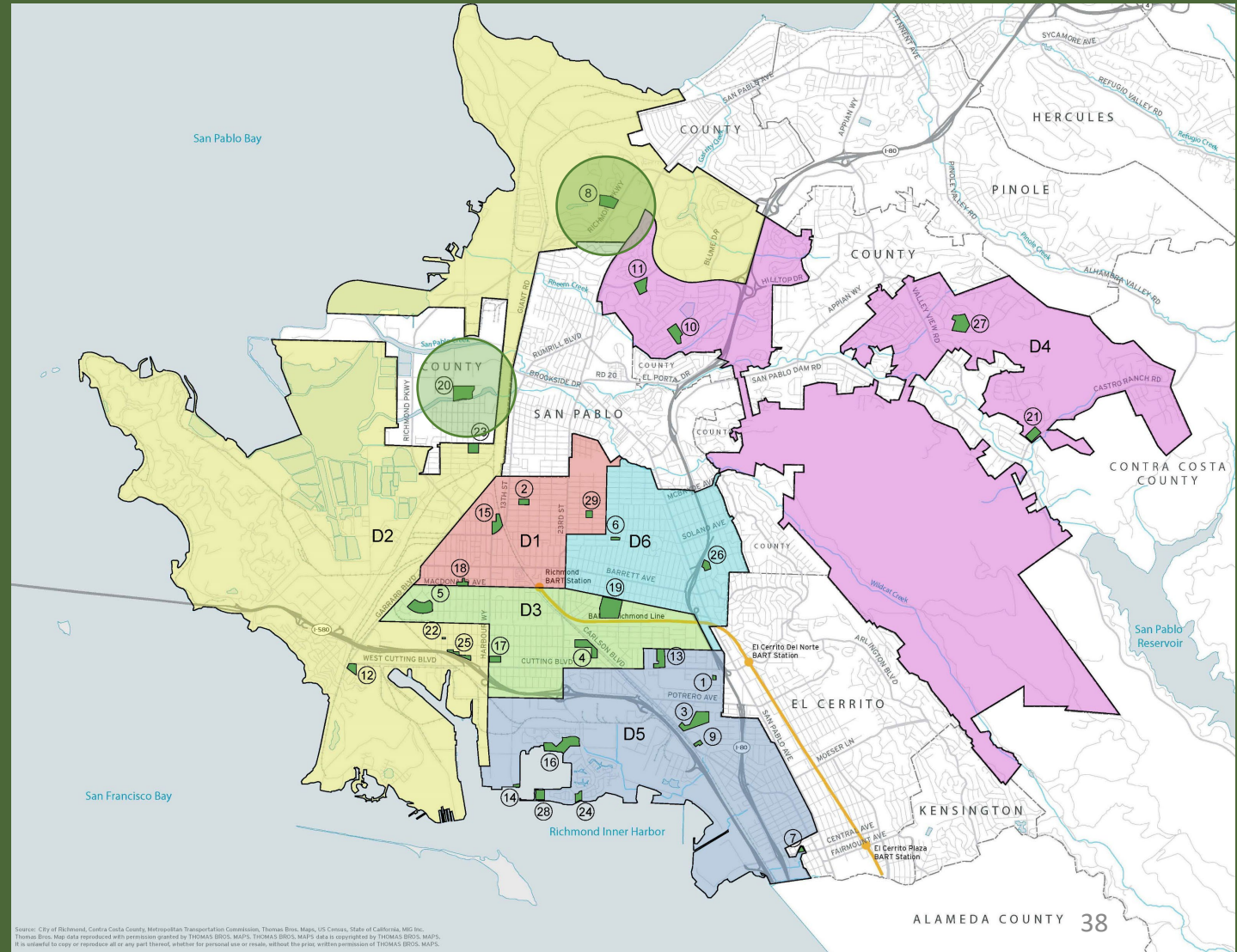



# RICHMOND FIELD ASSESSMENT

## JOINT USE PLAY

### Establish Joint Use Agreements

- **Hilltop Park**, surplus lands
- **Fairmede Park**, Highland Elementary School
- **LaMoine Park**, Valley View Elementary School
- **Olinda Elementary School**
- **State Court Park**, Kennedy High School
- **Nichol Park**, Lovonya De Jean Middle School

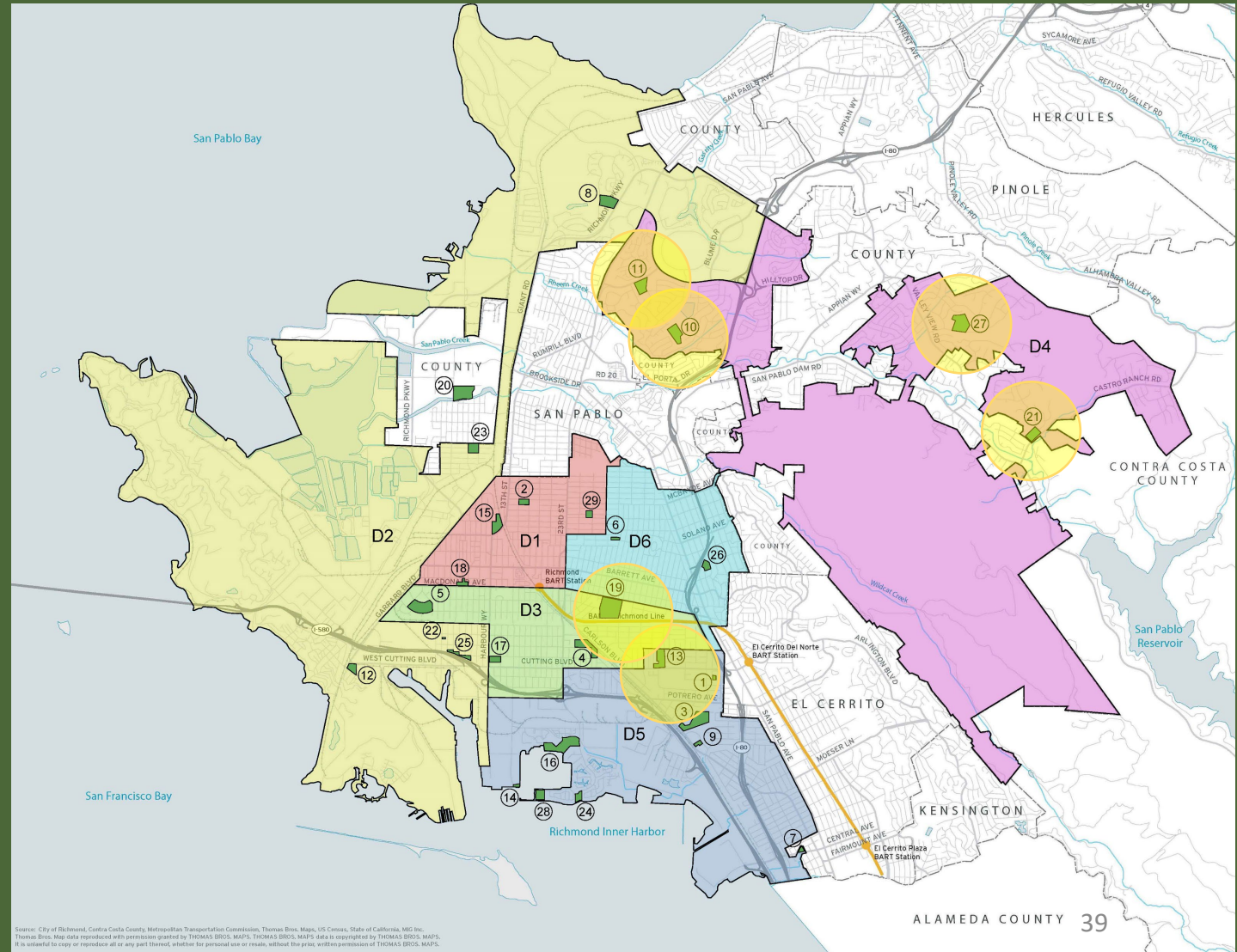

# RICHMOND FIELD ASSESSMENT

## APPLY FOR GRANTS

- **Booker T. Anderson Park** – apply for a grant to install artificial turf for multisport fields, renovate play area, install new restroom/concession building, install new basketball, tennis and pickle ball courts, lighting upgrades
- **Lucas Park** – apply for a grant to reconfigure the fields for multiuse, expand courts, modify play area, parking and restroom

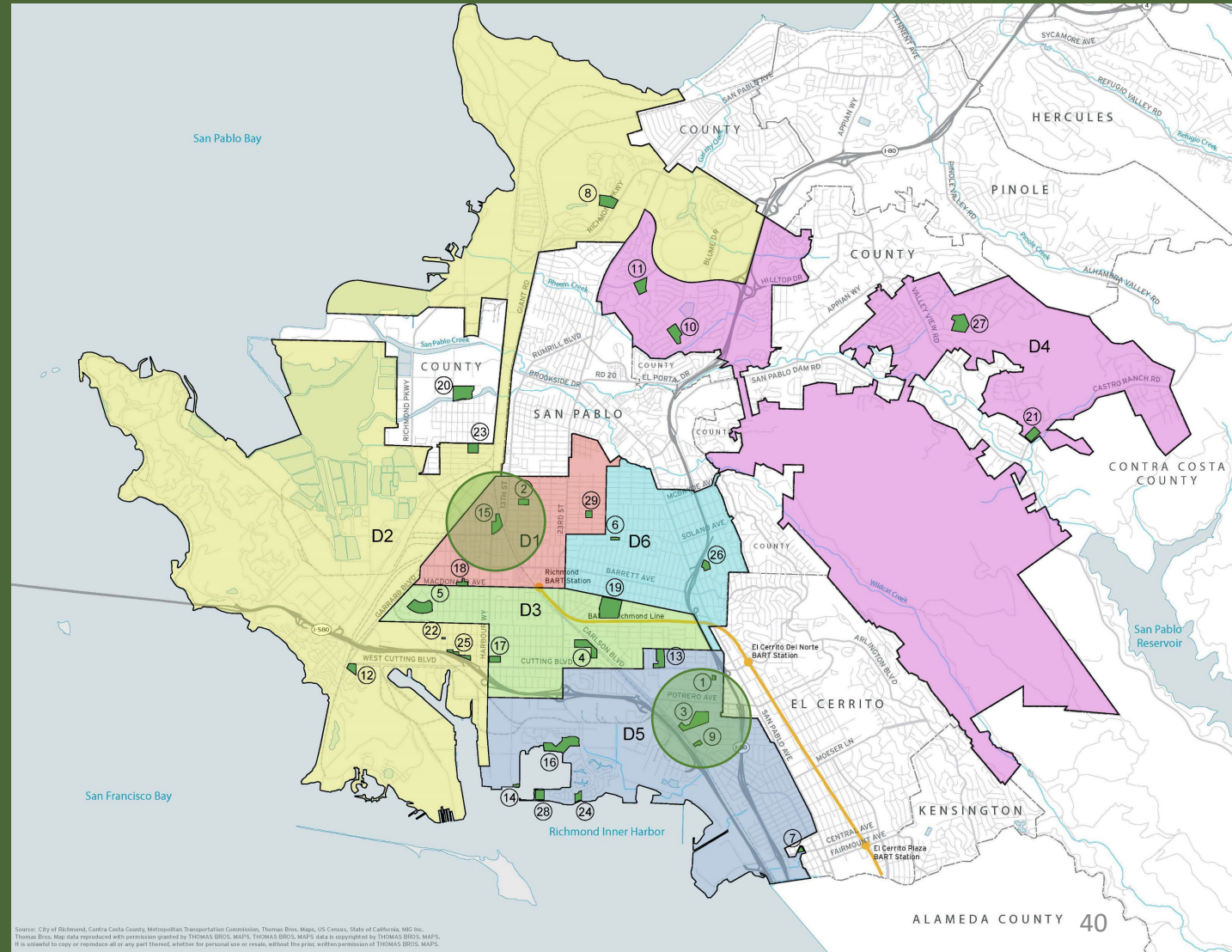



# RICHMOND FIELD ASSESSMENT

## APPLY FOR GRANT

- **Nichol Park** – apply for a grant to renovate the park to install artificial turf multisport fields, new fencing, new restroom/concession building, new basketball, tennis and pickle ball courts, new play area, new sand volleyball courts, new bocce and lawn bowling area, renovated skate park, increased parking and lighting

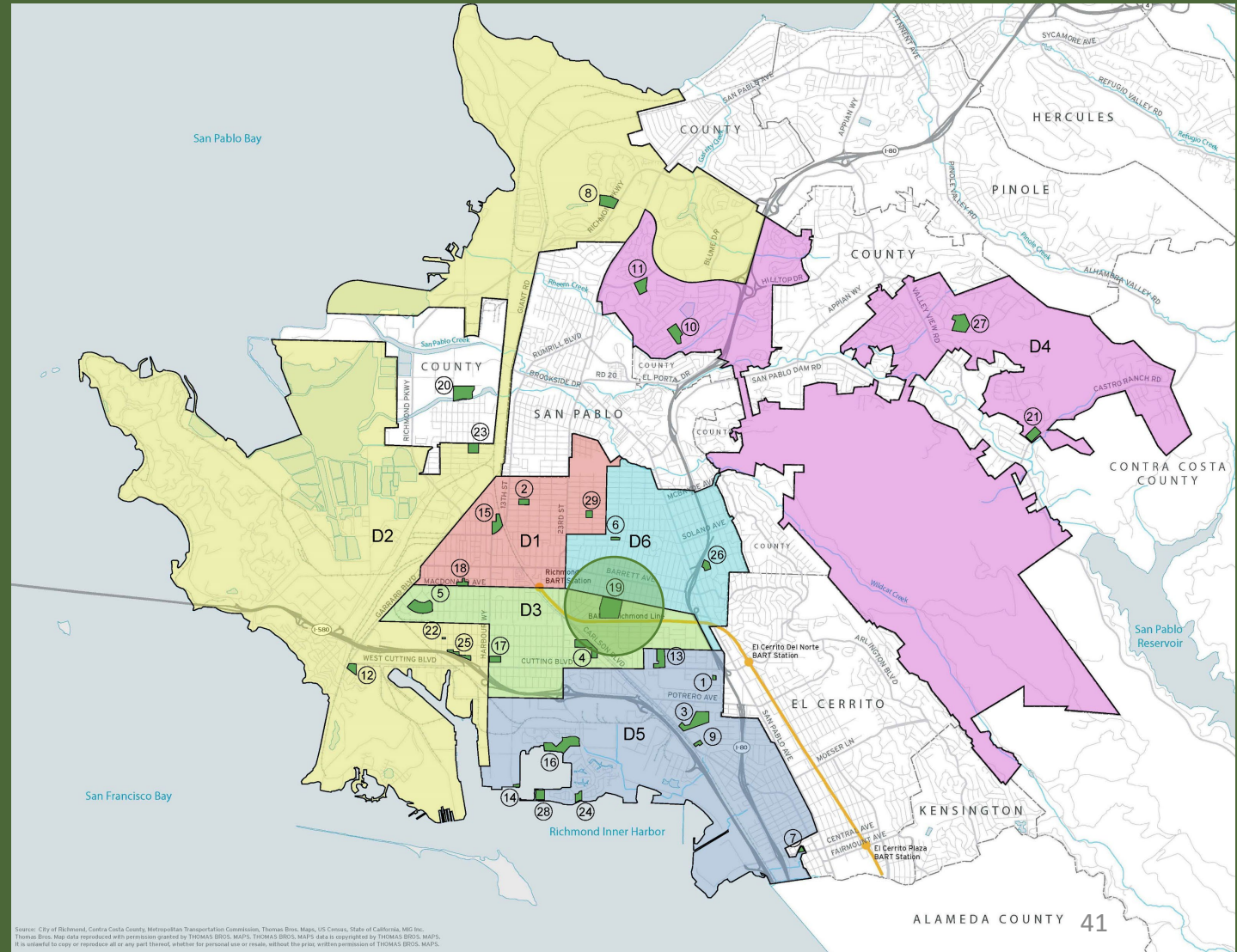

# RICHMOND FIELD ASSESSMENT

## OUTREACH

Work with the City Council, the community, neighborhood councils, sports leagues, and commissions to determine scope and priority of park improvements

- City Council direction on priority
- Initiate outreach to community and neighborhood councils adjacent to the selected park
- Prepare conceptual plans, cost estimates, grant application(s) and identify funding for implementation

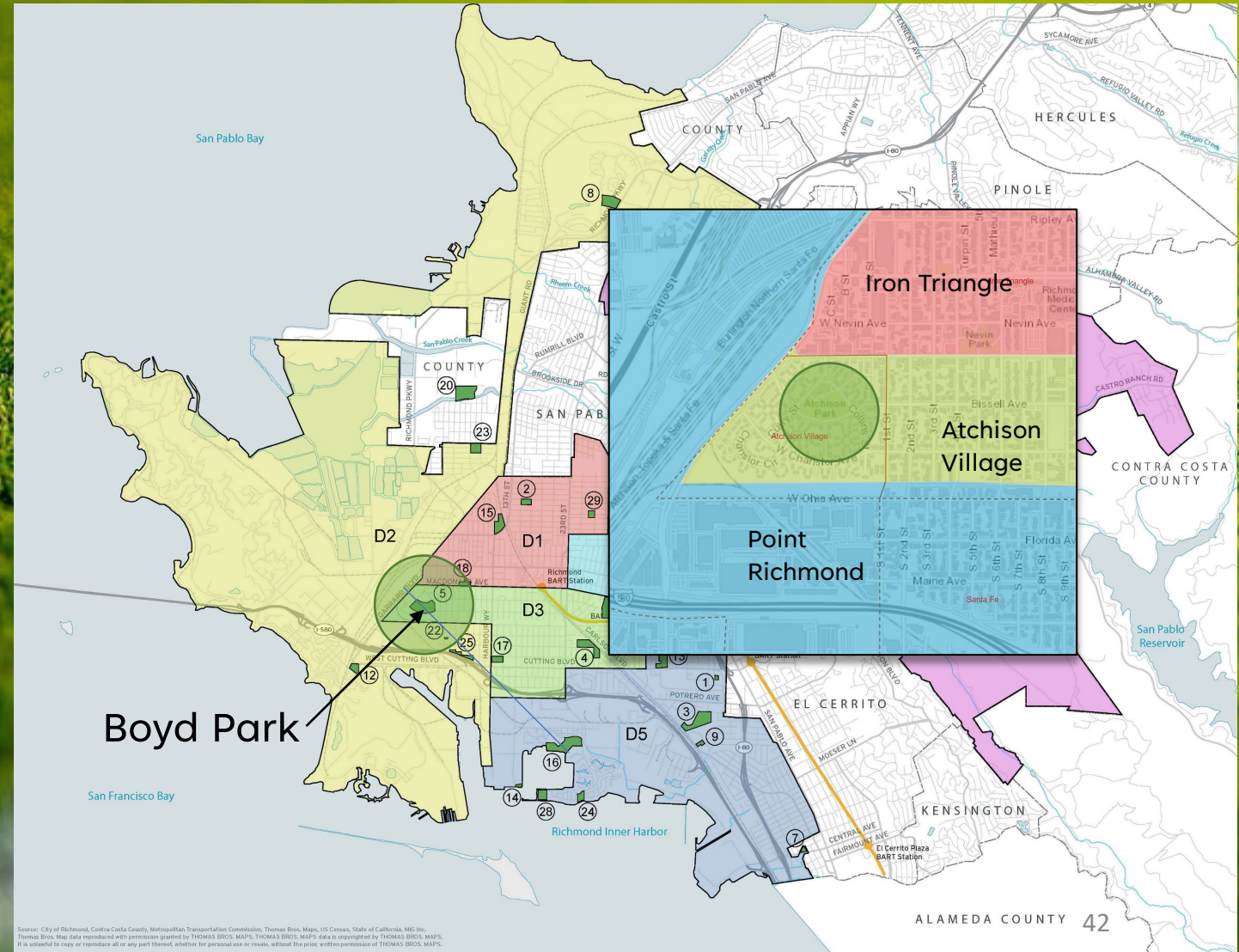

Source: City of Richmond, Contra Costa County, Metropolitan Transportation Commission, Thomas Bros. Maps, US Census, State of California, MGI Inc. Thomas Bros. Map data reproduced with permission granted by THOMAS BROS. MAPS. THOMAS BROS. MAPS data is copyrighted by THOMAS BROS. MAPS. It is unlawful to copy or reproduce all or any part thereof, whether for personal use or resale, without the prior, written permission of THOMAS BROS. MAPS.



# RICHMOND FIELD ASSESSMENT

## OUTREACH

Work with the City Council, the community, neighborhood councils, sports leagues, and commissions to determine scope and priority of park improvements

- City Council direction on priority
- Initiate outreach to community and neighborhood councils adjacent to the selected park
- Prepare conceptual plans, cost estimates, grant application(s) and identify funding for implementation

